

Specification

Individually designed kitchens

- Contemporary styled kitchen incorporating a choice of door and laminate worktops with upstand
- Bosch integrated single oven
- Bosch induction hob
- Integrated extractor
- Integrated fridge / freezer
- Integrated dishwasher
- Washer / dryer to utility cupboard (not integrated)
- Stainless steel sink with mixer tap

Heating, electrical & lighting

- Hot water heat pump providing hot water and electric radiators with central programmer
- Radiators with individual thermostatic control
- LED downlights to kitchen, bathroom and ensuite (only)

Quality bathrooms

- Contemporary styled bathroom
- Integrated vanity basin to main bathroom
- Matching mirrored wall unit including shaver socket to main bathroom
- Bathroom with shower over bath and screen
- WC with dual-flush plate, concealed cistern and soft-close seat
- Heated towel rail to bathroom
- Ceramic wall tiles to wet areas with feature tiling to integrated vanities
- Karndean (LVT) to bathroom and ensuite

Home entertainment & communications

- Digital TV aerial point in living room / dining area and bedroom 1
- USB charging points to kitchen and bedroom 1 (only)

Interior finishes

- Painted internal doors with chrome finish door furniture
- Full height wardrobe with sliding doors to bedroom 1
- Satin paint finish to all internal joinery
- Karndean flooring throughout the ground floor and living room if adjoining the kitchen
- Fitted carpets to stairs, landing, all bedrooms, and living room where separate from the kitchen

External

- External light to external area / balconies
- Paved area to ground floor apartments, balconies to first and second floor apartments
- Car charging point provided (charger provided to each plot in communal car park area)

Security & peace of mind

- High security front entrance door with multi-point locking system
- Mains fed smoke detector with battery backup, fitted to hall
- 10-Year building warranty provided by NHBC

SALES & MARKETING SUITE

Milton Keynes,
Buckinghamshire,
MK16 0JA

For further information or enquiries:

01908 036 485
eastbrookliving.co.uk
eastbrooksales@stjosephhomes.co.uk

Specification is at draft stage and subject to change. Kitchen layout is indicative only and may vary. Floorplans shown for Eastbrook Village are for approximate measurements only. Exact layouts and sizes may vary. All measurements may vary within a tolerance of 5%. The dimensions are not intended to be used for carpet sizes, appliance sizes or items of furniture. Furniture layouts are indicative only. Eastbrook Village is a marketing name and will not necessarily form part of the approved postal address. Site plan (including Marketing names) is indicative only and subject to change. Applicants are advised to contact Berkeley Homes to ascertain the availability of any particular property. Computer generated images of Eastbrook Village are indicative only. Type 2.2a. Issue Date: September 2025.

Berkeley
Designed for life



The Beech Apartments

1 bedroom apartment

Berkeley
Designed for life

The Beech Apartments

1 bedroom apartments

Total internal area: 52.2 sq m / 561.9 sq ft

Plots

109, 114, 120

Living/Dining

4.21m x 3.81m 13'10" x 12'6"

Kitchen

3.81m x 1.85m 12' 6" x 6' 1"

Bedroom 1

4.27m x 2.81m 13'10" x 12'6"

Balcony

3.28m x 1.79m 10'9" x 5'10"

Key

- C Cupboard
- W Wardrobe
- H Hot Water Heat Pump
- WM Washing Machine
- DW Dishwasher



Apartment Locator

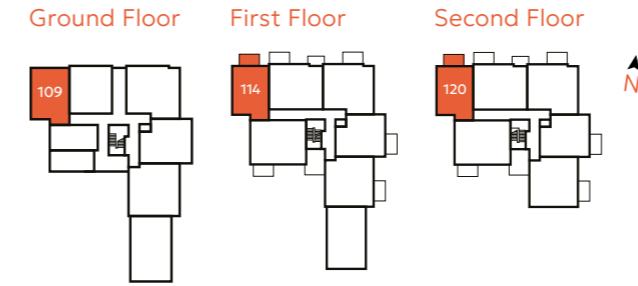

Site Map



The Beech Apartments

1 bedroom apartment
 Total internal area: 50.7 sq m / 545.7 sq ft

Plot
 110

- Living/Dining
 4.57m x 3.76m 15'0" x 12'4"
- Kitchen
 2.99m x 2.25m 9'10" x 7'5"
- Bedroom 1
 5.30m x 2.86m 17'5" x 9'4"

- Key
- C Cupboard
 - W Wardrobe
 - H Hot Water Heat Pump
 - WM Washing Machine
 - DW Dishwasher



Apartment Locator

Ground Floor

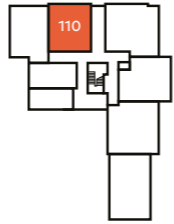

Site Map

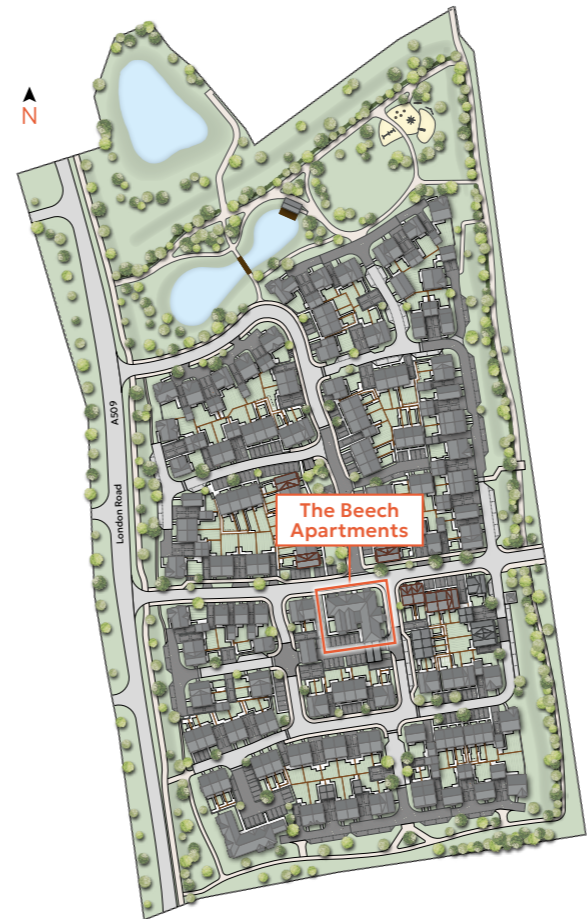

The Beech Apartments

2 bedroom apartments
 Total internal area: 67.3 sq m / 724.4 sq ft

Plots
 111, 116 & 122

Living/Dining
 4.99m x 3.63m 16'5" x 11'11"

Kitchen
 4.16m x 1.85m 13'8" x 6'1"

Bedroom 1
 3.53m x 3.43m 11'7" x 11'3"

Bedroom 2
 4.16m x 2.85m 13'8" x 9'4"

Balcony
 3.28m x 1.79m 10'9" x 5'10"

- Key
- C Cupboard
 - W Wardrobe
 - H Hot Water Heat Pump
 - WM Washing Machine
 - DW Dishwasher



Apartment Locator

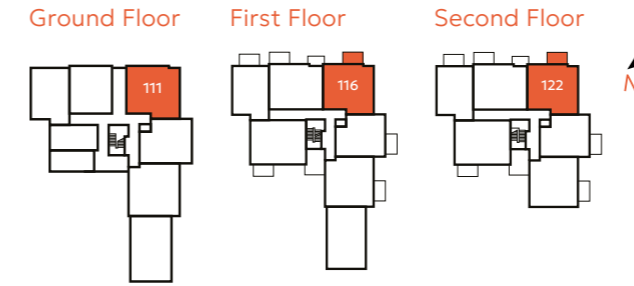

Site Map



The Beech Apartments

1 bedroom apartments
 Total internal area: 54.9 sq m / 590.9 sq ft

Plots
 112, 117 & 123

- Living/Dining
 4.97m x 3.73m 16'4" x 12'3"
- Kitchen
 3.40m x 2.51m 11'2" x 8'3"
- Bedroom 1
 4.23m x 3.22m 13'10" x 10'7"
- Balcony
 3.28m x 1.79m 10'9" x 5'10"

- Key
- C Cupboard
 - W Wardrobe
 - H Hot Water Heat Pump
 - WM Washing Machine
 - DW Dishwasher



Apartment Locator

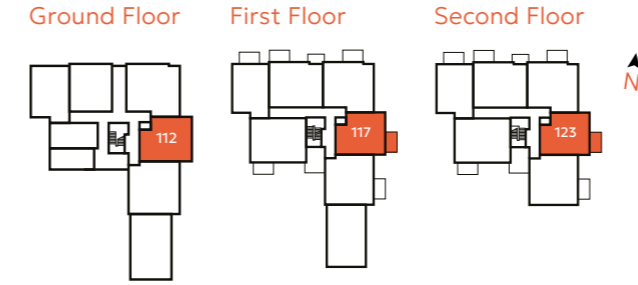

Site Map



The Beech Apartments

2 bedroom apartments
 Total internal area: 67.7 sq m / 728.7 sq ft

Plots
 113, 118 & 124

Living/Dining
 5.02m x 4.22m 16'6" x 13'10"

Kitchen
 3.13m x 2.53m 10'3" x 8'3"

Bedroom 1
 5.02m x 3.18m 16'6" x 10'5"

Bedroom 2
 3.31m x 2.85m 10'10" x 9'4"

Balcony
 3.28m x 1.79m 10'9" x 5'10"

- Key
- C Cupboard
 - W Wardrobe
 - H Hot Water Heat Pump
 - WM Washing Machine
 - DW Dishwasher

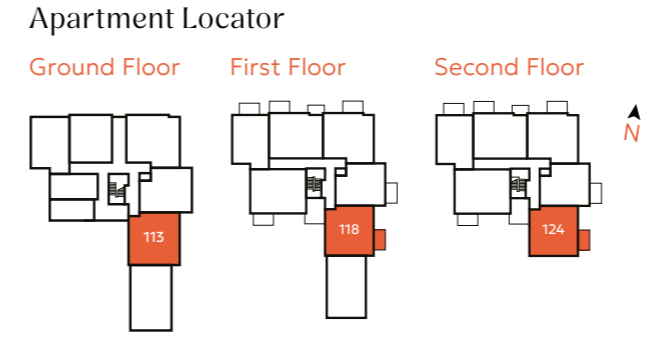

The Beech Apartments

2 bedroom apartments

Total internal area: 67.8 sq m / 729.8 sq ft

Plots

115 & 121

Living/Dining

5.33m x 3.40m 17'6" x 11'2"

Kitchen

2.68m x 2.26m 8'10" x 7'5"

Bedroom 1

4.96m x 2.76m 16'4" x 9'1"

Bedroom 2

4.16m x 2.75m 13'8" x 9'0"

Balcony

3.28m x 1.79m 10'9" x 5'10"

Key

- C Cupboard
- W Wardrobe
- H Hot Water Heat Pump
- WM Washing Machine
- DW Dishwasher



Apartment Locator

First Floor

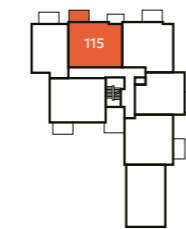

Second Floor

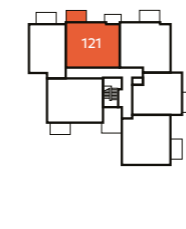

Site Map



The Beech Apartments

2 bedroom apartments

Total internal area: 69.8 sq m / 751.3 sq ft

Plots

119 & 125

Living/Dining

5.16m x 3.63m 16'11" x 11'11"

Kitchen

2.99m x 2.26m 9'10" x 7'5"

Bedroom 1

5.16m x 2.76m 16'11" x 9'1"

Bedroom 2

4.01m x 2.79m 13'2" x 9'2"

Balcony

3.28m x 1.79m 10'9" x 5'10"

Key

- C Cupboard
- W Wardrobe
- H Hot Water Heat Pump
- WM Washing Machine
- DW Dishwasher



Apartment Locator

First Floor

Second Floor

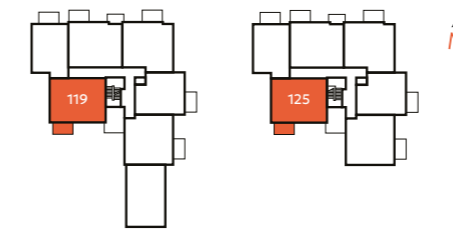

Site Map

