

THE GREEN QUARTER

WEST LONDON

ARBER HOUSE & EDWIN HOUSE



Berkeley
Designed for life.



CONTENTS

02

The Green Quarter

04

Development Plan

06

Parkside

08

Arber House &
Edwin House

10

Residents'
Facilities

12

Interiors

18

Interior Selections

20

Specifications

22

Arber House
Floorplans

34

Edwin House
Floorplans

46

Why Berkeley

50

MyHome Plus

54

Contact

REMARKABLE BY NATURE

WELCOME TO THE GREEN QUARTER

The Green Quarter is no ordinary place to live. Here, you'll enjoy the benefits of modern urban living in a truly remarkable setting, with nature at its very heart.

The transformation of this former brownfield site is one of London's most ambitious regeneration projects and will create one of the most biodiverse neighbourhoods in the UK.

Arber House and Edwin House are among the first apartment buildings to benefit from these emerging green spaces.

Each home is designed to make the most of the natural setting, with private balconies overlooking podium gardens and out across the new 4.5-acre Central Gardens just beyond.

With a selection of suites, one, two and three bedroom apartments, you'll also enjoy the flexibility of super-fast transport connections into central London, with the zone 4 tube station a short stroll away.

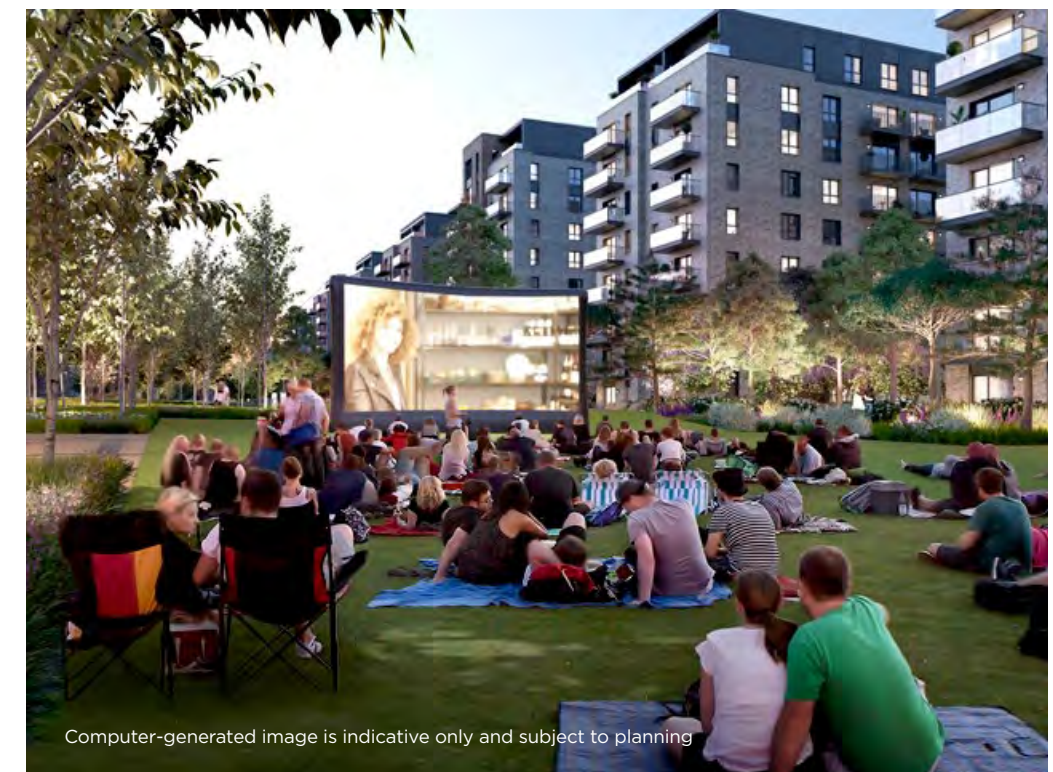

Computer-generated image is indicative only and subject to planning

ARBER HOUSE & EDWIN HOUSE

The homes at Arber House and Edwin House are located in Parkside, one of four new and distinct areas to emerge at The Green Quarter.

From the outset, you'll be able to enjoy the new public Central Gardens as well as your own, residents-only podium garden at the foot of your apartment building.

ARBER HOUSE		EDWIN HOUSE	
Apartment Type		Apartment Type	
Suites	36	Suites	36
1 Bedroom	22	1 Bedroom	22
2 Bedrooms	28	2 Bedrooms	28
3 Bedrooms	2	3 Bedrooms	2

The Green Quarter Masterplan

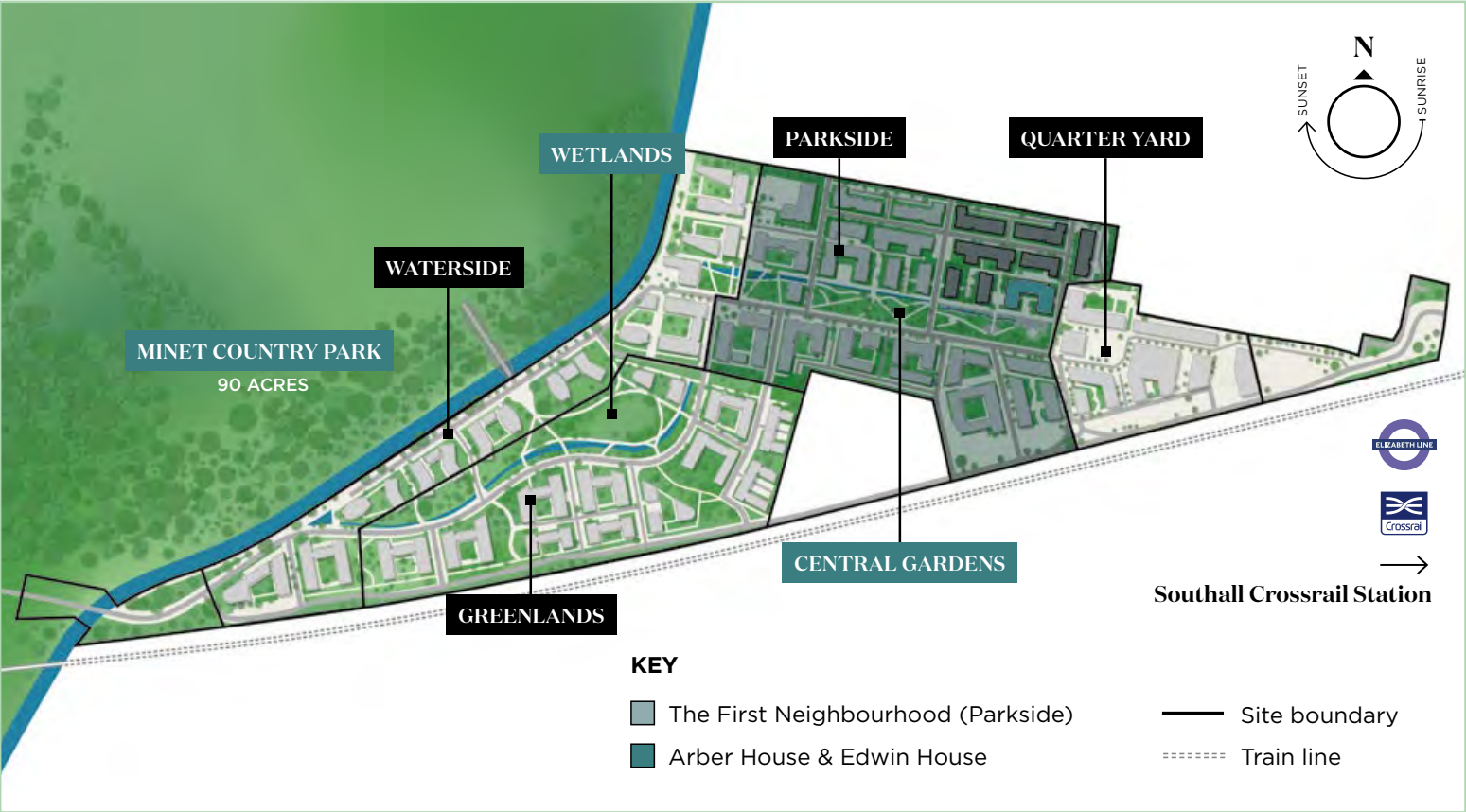

Maps are not to scale and show approximate locations only. The site plan is indicative only and subject to change. In line with our policy of continuous improvement we reserve the right to alter the layout, building style, landscaping and specification at anytime without notice. Site plan is indicative only and subject to change. *Right to park only.



PARKSIDE

Between the apartments and the tree-lined boulevard below is a series of neighbourhood spaces the community can use.

Computer-generated image is indicative only and subject to planning

Looking out over the four-acre Central Gardens, Parkside is the first of the new neighbourhoods to be created at The Green Quarter.

Apartments nestle among the trees, offering stunning views across landscaped grounds, trickling waterways and areas for recreation or community activities.

ARBER HOUSE & EDWIN HOUSE

Reflecting the same attention to detail brought to every project by Berkeley Group, the apartments at Arber House and Edwin House are designed to be spacious and modern with views over stunning green spaces.

Arber House

The name for Arber House derives from British plant anatomist, biology philosopher and botanist, Agnes Arber. In 1946, she was the first woman to be elected as a Fellow of the Royal Society and paved the way for other women to follow in her footsteps.

With the Central Gardens situated in front of the building, the strong connection to nature continues through new planting and biodiverse spaces.

Edwin House

With its close proximity to the city and the waterways, this whole area has a rich industrial history. The Martin Brothers – Edwin, Wallace, Charles and Walter – established a pottery in Southall where they produced a distinctive type of stoneware. Nowadays, this is highly collectable and displayed in some of the most prestigious galleries in the country.

RIGHT -
View of Arber House and
Edwin House shown from
Central Gardens



Computer-generated image is indicative only and subject to planning.

RESIDENTS' FACILITIES

Arber House and Edwin House offer you exclusive access to all the amenities you need for an effortless lifestyle.

Individual health and wellbeing is crucial to the strength of the community at The Green Quarter.

SWIMMING POOL
GYM
SCREENING ROOM
LOUNGE & CO-WORKING SPACE
CONCIERGE
CAR CLUB
CYCLE STORAGE & HIRE
PARKING*

Photograph of a previous Berkeley development, indicative only

With access to a fully equipped gym and swimming pool, you'll be able to exercise at your convenience.

You can rely on your own concierge located at The Green Quarter to take care of everyday needs and we have created co-working spaces with super-fast broadband and all the latest tech to allow for that extra bit of flexibility in your day.



TOP LEFT -
Swimming pool
RIGHT -
Lounge & co-working space
OPPOSITE PAGE -
Gym
LEFT -
Concierge



*Subject to extra cost

CONTEMPORARY INTERIORS



In Arber House and Edwin House, the open and spacious living areas are flooded with natural light. These generous spaces offer expansive French windows that open out onto your own private balcony – perfect for entertaining or relaxing at home in ultimate comfort.

THE SPACE TO ENTERTAIN

Taking inspiration from the area's industrial heritage, and its nature-filled future, the designs for interior dining and living spaces involve subtle contrasts.

From the natural timber flooring to the white window surrounds, these unique interior styles create a timeless appeal.

Kitchen areas are designed to resemble a seamless piece of joinery. And this harmony continues through the open living areas and into the bedrooms of each apartment.

These are apartments designed for modern living. The kind of spaces in which you'll feel equally comfortable entertaining or kicking off your shoes and taking it easy.

RIGHT -
Stylish contemporary
kitchen designs featuring
natural timber flooring



BUILDING FOR THE FUTURE

From construction through to the finishing touches, The Green Quarter incorporates a whole host of features to help reduce environmental impact.

Take the rainwater harvesting for irrigating landscaped areas and the green roofs on every apartment building. Or the water-saving fixtures in the bathrooms and 100% low energy lighting throughout each home.

White goods are supplied, rated B or above and communal heating and hot water via an energy centre.

LEFT -
The bedroom is a calm and contemporary sanctuary that you can relax in

BELOW -
Enjoy the feeling of undeniably indulgent finishes in your stunning new shower room

All apartments at Arber House and Edwin House are designed with the future in mind and make it easier for you to live a sustainable lifestyle.

Interior photography is of showhome and is indicative only



Interior photography is of showhome and is indicative only

YOUR CHOICE OF INTERIORS

Personalise your interiors with a custom selection of alternative carpet and timber floor colours.

Finished in either a classic or contemporary palette that you can style yourself, mix-and-match the options to create your perfect home*.

01 Carpet choices



Light



Medium



Dark

02 Timber floors

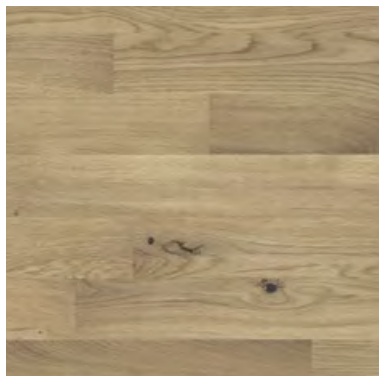

Natural

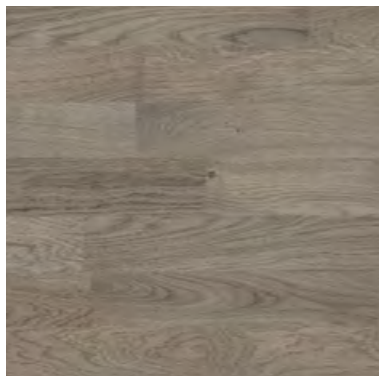

Washed

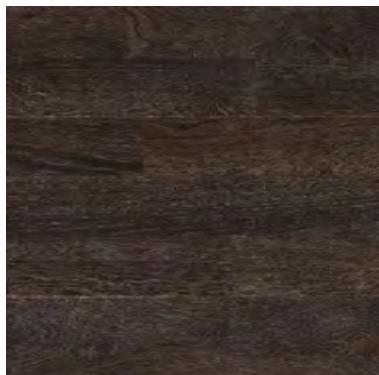

Dark

Each finish has been hand-picked to accentuate the space, light and design of your apartment.

03 Style palettes

Classic palette

A stylish combination of white kitchen units and a white herringbone tiled splashback create a timeless aesthetic.



KITCHEN
White base units and wall units.

KITCHEN FLOORING
Natural timber.

Contemporary palette

By bringing together cooling tones and vibrant patterns you can form a modern, stylish interior decor.



KITCHEN
Dust grey base units and white wall units.

KITCHEN FLOORING
Natural timber.

*Available to selected homes only. Interior photography is of showhome and is indicative only. Your attention is drawn to the fact that in rare circumstances it may not be possible to obtain the exact products or materials referred to in the specification. Berkeley reserves the right to alter, amend or update the specification, which may include changes in the colour, material and/or brand specified. In such cases, a similar alternative will be provided. Berkeley reserves the right to make these changes as required.

STYLE ENHANCED

Berkeley has established a collection of high quality fixtures and fittings that uniquely belong to The Green Quarter.

KITCHENS

- Fully custom-designed fitted kitchen with handleless soft-close units
- Lacquer finish to all doors
- Silestone worktops with under-mounted stainless steel sink
- Feature herringbone tiled splashback
- Bosch integrated oven
- Bosch integrated fridge/freezer to one, two and three bedroom apartments
- Bosch under-counter fridge with freezer compartment to all suites
- Bosch integrated dishwasher
- Integrated extractor hood
- Bosch wide 4-ring ceramic hob
- Brushed stainless steel tap
- Space saving pull-out recycling bins
- Integrated wine cooler available at extra cost as optional upgrade and subject to build stage. Built as standard to top floor apartments
- Bosch freestanding washer/dryer to utility cupboard

COMMUNAL AREAS

- Movement controlled lighting to all corridors and car park
- Lifts to all floors
- Access controlled car park and cycle storage
- Electric car charging points in basement car park and street level

BATHROOMS

- Tiling to wet area walls and floor
- Roca sanitaryware throughout
- Tiled countertop and splashback with ceramic wash basin
- Polished chrome Hansgrohe monoblock thermostatic mixer tap to wash basin
- Wall-mounted dual flush WC with concealed cistern
- Hansgrohe chrome thermostatic mixer tap and hand shower over bath
- Glass bath screen
- Electric heated chrome towel rail
- Wall-mounted cabinet with mirrored door, LED lighting and open shelves
- White shaver socket

SHOWER ROOMS*

- Tiling to wet area walls
- Tiling to floor
- Roca sanitaryware throughout
- Tiled countertop and splashback with ceramic wash basin
- Wall-mounted Hansgrohe dual flush WC with concealed cistern
- Hansgrohe chrome thermostatic shower mixer and hand shower
- Glass shower screen
- Electric heated chrome towel rail
- Wall-mounted cabinet with mirrored door, LED lighting and open shelves
- White shaver socket

LIGHTING/ELECTRICAL FITTINGS

- Orcomm video entry system linked to building entrance which incorporates Smart Home Technology**
- Smart Home Technology**
- Lighting, heating and blind/curtain control to top floor apartments
- USB sockets to bedroom/s
- TV point in bedroom/s
- Heating controls to kitchen and living room
- Recessed low energy white downlights throughout
- Stainless steel sockets to kitchens, white elsewhere

INTERIOR FINISHES

- Timber veneer entrance door with matte bronze finish lever handle
- White internal doors
- White painted skirting
- White painted architraves
- Hallway coat/utility cupboard
- Sliding mirrored wardrobe to master bedroom
- White painted internal walls and ceilings
- Engineered timber floor throughout living area, kitchen and hallway
- Carpet to all bedrooms except type P7 suite



Interior photography is of showhome and is indicative only

TELECOMMUNICATIONS

- Provision for Sky services in living room and master bedroom
- Provision for fibre broadband
- Telephone sockets to living room and master bedroom

HEATING/VENTILATION

- White radiators throughout
- Electric heated towel rail to bathrooms and ensuites
- Continuous Mechanical Extract Ventilation
- Heating controls to kitchen and living room

SECURITY/PEACE OF MIND

- 10-year NHBC warranty
- Communal CCTV system
- Entrance to building via key remote fob and intercom
- Gated private courtyard and basement car park controlled by Automatic Numberplate Recognition
- 999-year lease
- Apartment entrance door with multi-point locking system and spyhole

PRIVATE EXTERNAL AREAS

- External private amenity space
- Paving or MyDek aluminium decking to balcony/terrace dependent on location*
- Metal or glass balustrades to balconies – dependent on location*
- Wall-mounted external light to balcony/terrace

Specification Upgrades

Upgrade Smart Home Technology lighting control available

Integrated wine cooler† Car parking available†

**Available at extra cost, subject to timeframes and availability.

†Available at extra cost to selected apartments only. Subject to timeframes and availability.

*Available to selected homes only. Showhome photography is indicative only and subject to change. Your attention is drawn to the fact that in rare circumstances it may not be possible to obtain the exact products or materials referred to in the specification. Berkeley reserves the right to alter, amend or update the specification, which may include changes in the colour, material and/or brand specified. In such cases, a similar alternative will be provided. Berkeley reserves the right to make these changes as required.



FLOORPLANS

ARBER HOUSE

Suites, 1, 2 & 3 bedroom apartments



ARBER HOUSE

FLOORPLATES

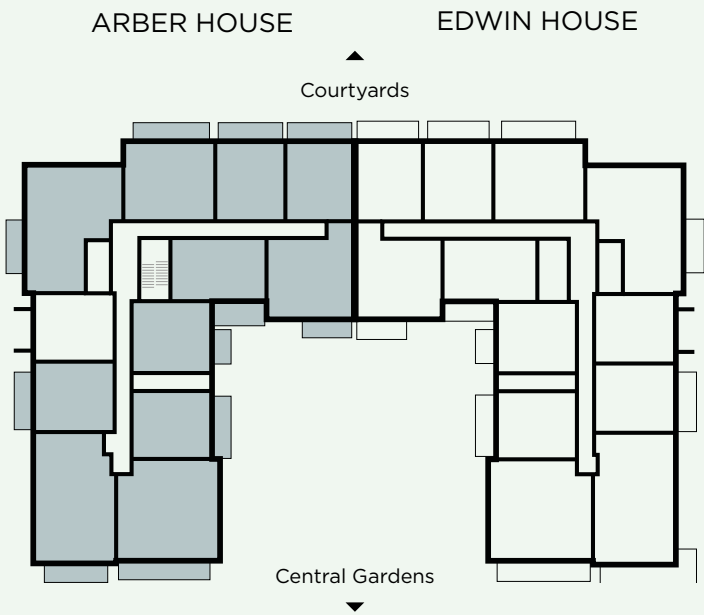

LOCATION MAP

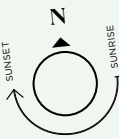
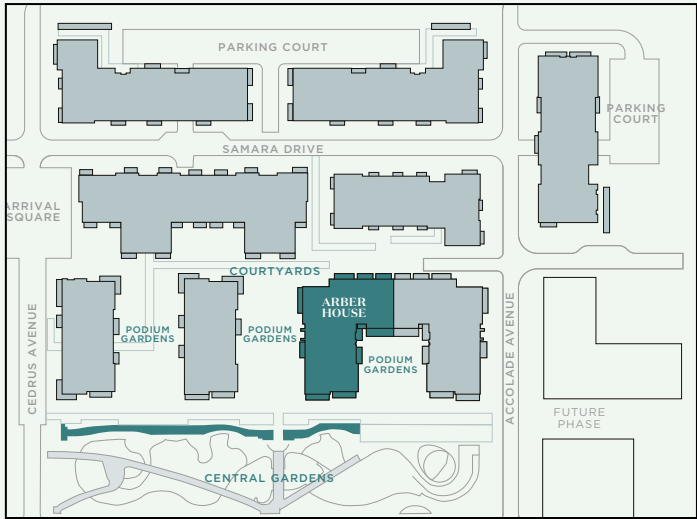

Maps are indicative only and subject to change.

ARBER & EDWIN HOUSE

GROUND FLOOR



FIRST FLOOR



SECOND FLOOR



THIRD FLOOR



FOURTH FLOOR



FIFTH FLOOR

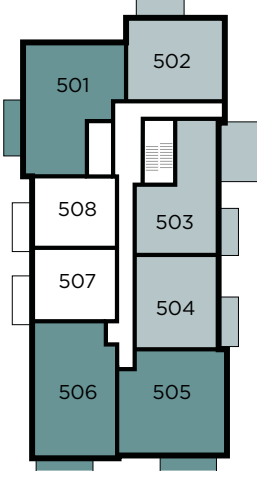

SIXTH FLOOR



SEVENTH FLOOR

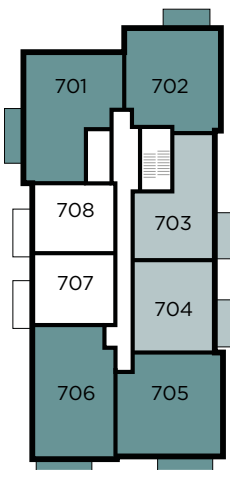

EIGHTH FLOOR

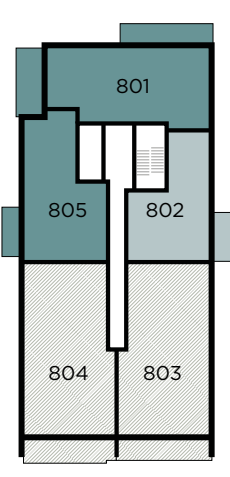

KEY

- Suite Apartments
- 1 Bedroom Apartments
- 2 Bedroom Apartments
- 3 Bedroom Apartments

ARBER HOUSE

2 BEDROOM

TYPE P20
APARTMENT 805

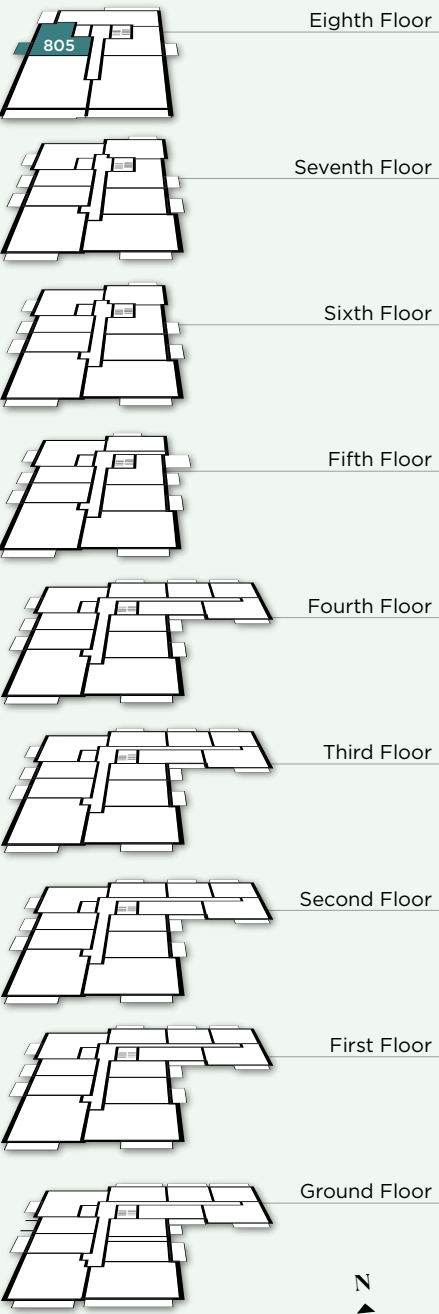

KEY	
W	Wardrobe
C	Cupboard
U	Utility
◄►	Measurement Points
.....	Bulkhead
----	Terrace Area (if applicable)

THE GREEN QUARTER

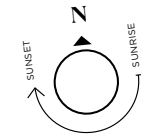

TOTAL AREA	64.67 sq m	696 sq ft	Kitchen	4.09m x 3.69m	13' 5" x 12' 1"
Balcony total area	6.06 sq m	65 sq ft	Living Room	4.09m x 1.86m	13' 4" x 6' 1"
			Bedroom 1	4.11m x 3.50m	13' 5" x 11' 6"
			Bedroom 2	2.93m x 3.00m	9' 7" x 9' 10"
			Balcony	1.50m x 4.04m	4' 11" x 13' 3"

Floorplans shown for The Green Quarter are for approximate measurements only. Exact layout, sizes, measurements and areas may vary within a tolerance of 5%. The net sales area is based on the RICS standard method of measurement and is the internal area of the home including internal columns and service boxing. The dimensions and areas are not intended to be used for carpet sizes, appliance sizes or items of furniture. Furniture and kitchen layouts are indicative only. Colours are indicative only and may vary depending on the customer palette selection. Views are indicative only. Landscaping on balconies and terraces is indicative only. Please note, to increase legibility these plans have been sized to fit the page. As a result this plan may not be at the same scale as those on other pages.

ARBER & EDWIN HOUSE

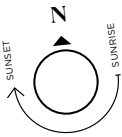

TOTAL AREA	62.34 sq m	671 sq ft	Kitchen	4.24m x 2.52m	13' 11" x 8' 3"
Balcony total area	6.06 sq m	65 sq ft	Living Room	4.24m x 2.83m	13' 11" x 9' 3"
			Bedroom 1	3.31m x 3.31m	10' 10" x 10' 10"
			Bedroom 2	4.24m x 3.13m	13' 11" x 10' 3"
			Balcony	4.04m x 1.50m	13' 3" x 4' 11"

Floorplans shown for The Green Quarter are for approximate measurements only. Exact layout, sizes, measurements and areas may vary within a tolerance of 5%. The net sales area is based on the RICS standard method of measurement and is the internal area of the home including internal columns and service boxing. The dimensions and areas are not intended to be used for carpet sizes, appliance sizes or items of furniture. Furniture and kitchen layouts are indicative only. Colours are indicative only and may vary depending on the customer palette selection. Views are indicative only. Landscaping on balconies and terraces is indicative only. Please note, to increase legibility these plans have been sized to fit the page. As a result this plan may not be at the same scale as those on other pages.

ARBER HOUSE

2 BEDROOM

TYPE P21
APARTMENTS 602 & 702

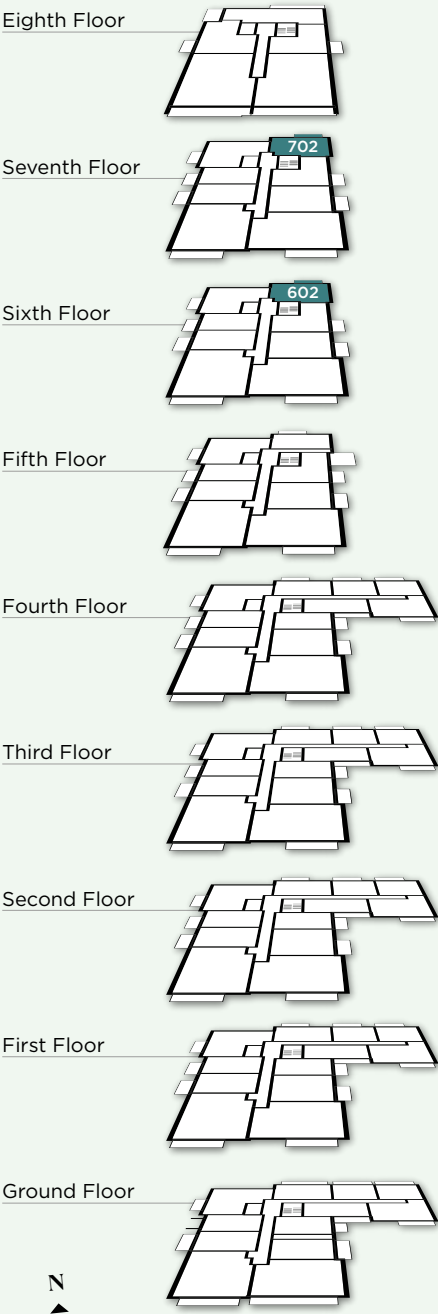

KEY	
W	Wardrobe
C	Cupboard
U	Utility
◄►	Measurement Points
.....	Bulkhead
----	Terrace Area (if applicable)

ARBER HOUSE

2 BEDROOM

TYPE P22
APARTMENTS 109, 209, 309,
409, 505, 605 & 705

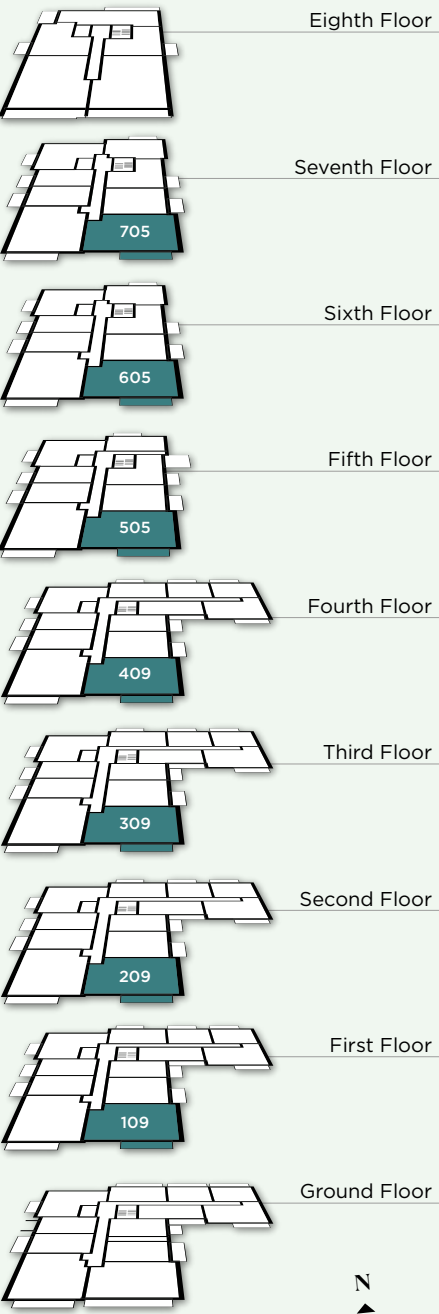

KEY	
W	Wardrobe
C	Cupboard
U	Utility
◄►	Measurement Points
.....	Bulkhead
----	Terrace Area (if applicable)

THE GREEN QUARTER

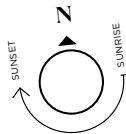

TOTAL AREA	70.61 sq m	760 sq ft	Kitchen	3.18m x 2.52m	10' 5" x 8' 3"
Balcony total area	7.08 sq m	76 sq ft	Living Room	5.08m x 2.64m	16' 8" x 8' 8"
			Bedroom 1	5.08m x 3.10m	16' 8" x 10' 2"
			Bedroom 2	3.54m x 2.75m	11' 7" x 9' 0"
			Balcony	4.72m x 1.50m	15' 5" x 4' 11"

Floorplans shown for The Green Quarter are for approximate measurements only. Exact layout, sizes, measurements and areas may vary within a tolerance of 5%. The net sales area is based on the RICS standard method of measurement and is the internal area of the home including internal columns and service boxing. The dimensions and areas are not intended to be used for carpet sizes, appliance sizes or items of furniture. Furniture and kitchen layouts are indicative only. Colours are indicative only and may vary depending on the customer palette selection. Views are indicative only. Landscaping on balconies and terraces is indicative only. Please note, to increase legibility these plans have been sized to fit the page. As a result this plan may not be at the same scale as those on other pages.

ARBER & EDWIN HOUSE

ARBER HOUSE

2 BEDROOM

TYPE P22(V2)
APARTMENT 009

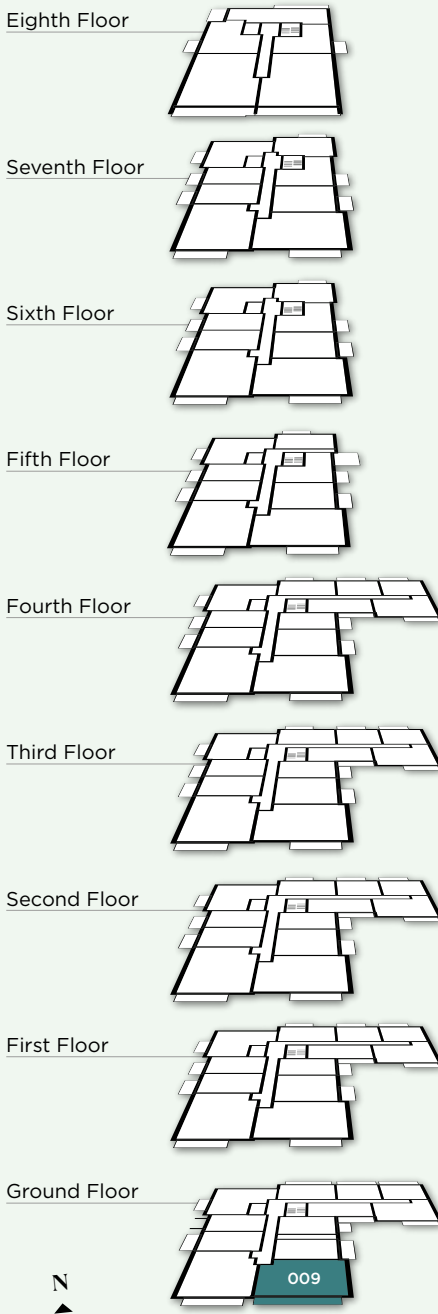

KEY	
W	Wardrobe
C	Cupboard
U	Utility
◄►	Measurement Points
.....	Bulkhead
----	Terrace Area (if applicable)



TOTAL AREA	71.18 sq m	766 sq ft	Kitchen	3.18m x 2.52m	10' 5" x 8' 3"
Terrace total area	12.06 sq m	129 sq ft	Living Room	5.08m x 2.64m	16' 8" x 8' 8"
			Bedroom 1	5.08m x 3.10m	16' 8" x 10' 2"
			Bedroom 2	3.54m x 2.76m	11' 7" x 9' 1"
			Terrace	8.04m x 1.50m	26' 4" x 4' 11"

Floorplans shown for The Green Quarter are for approximate measurements only. Exact layout, sizes, measurements and areas may vary within a tolerance of 5%. The net sales area is based on the RICS standard method of measurement and is the internal area of the home including internal columns and service boxing. The dimensions and areas are not intended to be used for carpet sizes, appliance sizes or items of furniture. Furniture and kitchen layouts are indicative only. Colours are indicative only and may vary depending on the customer palette selection. Views are indicative only. Landscaping on balconies and terraces is indicative only. Please note, to increase legibility these plans have been sized to fit the page. As a result this plan may not be at the same scale as those on other pages.

ARBER HOUSE

2 BEDROOM

TYPE P23
APARTMENT 010

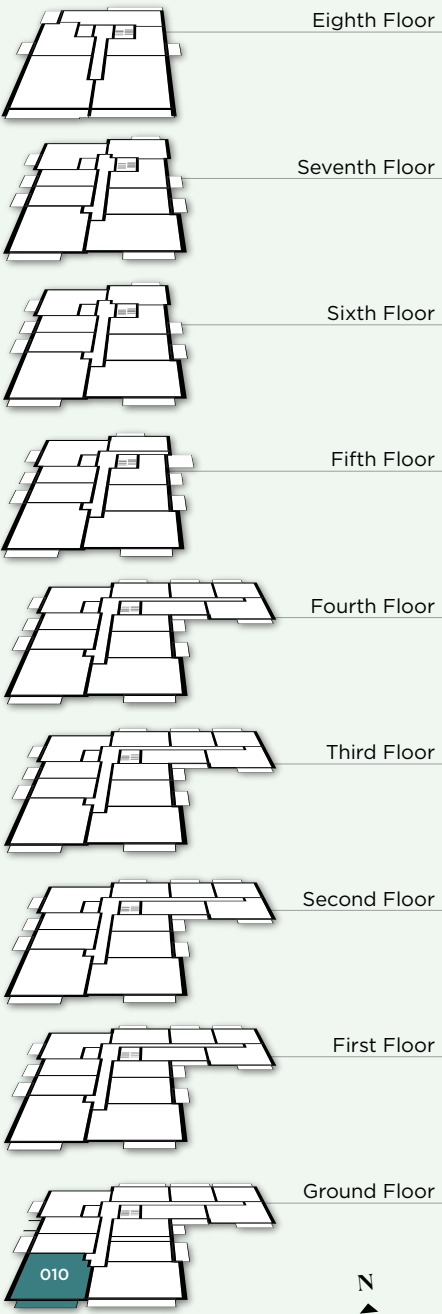

KEY

- W Wardrobe
- C Cupboard
- U Utility
- ◄► Measurement Points
- Bulkhead
- Terrace Area (if applicable)

THE GREEN QUARTER

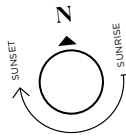

TOTAL AREA	70.92 sq m	763 sq ft	Kitchen	1.92m x 4.15m	6' 4" x 13' 8"
Terrace total area	7.89 sq m	84 sq ft	Living Room	4.82m x 4.15m	15' 10" x 13' 8"
			Bedroom 1	3.35m x 3.65m	11' 0" x 12' 0"
			Bedroom 2	3.35m x 2.84m	11' 0" x 9' 4"
			Terrace	5.74m x 1.38m	18' 10" x 4' 6"

Floorplans shown for The Green Quarter are for approximate measurements only. Exact layout, sizes, measurements and areas may vary within a tolerance of 5%. The net sales area is based on the RICS standard method of measurement and is the internal area of the home including internal columns and service boxing. The dimensions and areas are not intended to be used for carpet sizes, appliance sizes or items of furniture. Furniture and kitchen layouts are indicative only. Colours are indicative only and may vary depending on the customer palette selection. Views are indicative only. Landscaping on balconies and terraces is indicative only. Please note, to increase legibility these plans have been sized to fit the page. As a result this plan may not be at the same scale as those on other pages.

ARBER & EDWIN HOUSE

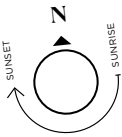

TOTAL AREA	70.84 sq m	762 sq ft	Kitchen	1.86m x 4.40m	6' 1" x 14' 4"
Balcony total area	7.00 sq m	75 sq ft	Living Room	3.01m x 6.75m	9' 10" x 22' 1"
Terrace total area	8.92 sq m	96 sq ft	Bedroom 1	2.97m x 3.11m	9' 9" x 10' 2"
			Bedroom 2	2.75m x 3.52m	9' 0" x 11' 6"
			Balcony	1.50m x 4.72m	4' 11" x 15' 5"
			Terrace	2.01m x 4.45m	6' 7" x 14' 7"

**Apartment 001 is a ground floor apartment and has a terrace in place of a balcony.

Floorplans shown for The Green Quarter are for approximate measurements only. Exact layout, sizes, measurements and areas may vary within a tolerance of 5%. The net sales area is based on the RICS standard method of measurement and is the internal area of the home including internal columns and service boxing. The dimensions and areas are not intended to be used for carpet sizes, appliance sizes or items of furniture. Furniture and kitchen layouts are indicative only. Colours are indicative only and may vary depending on the customer palette selection. Views are indicative only. Landscaping on balconies and terraces is indicative only. Please note, to increase legibility these plans have been sized to fit the page. As a result this plan may not be at the same scale as those on other pages.

ARBER HOUSE

2 BEDROOM

TYPE P24
APARTMENTS 001**, 101, 201,
301, 401, 501, 601 & 701

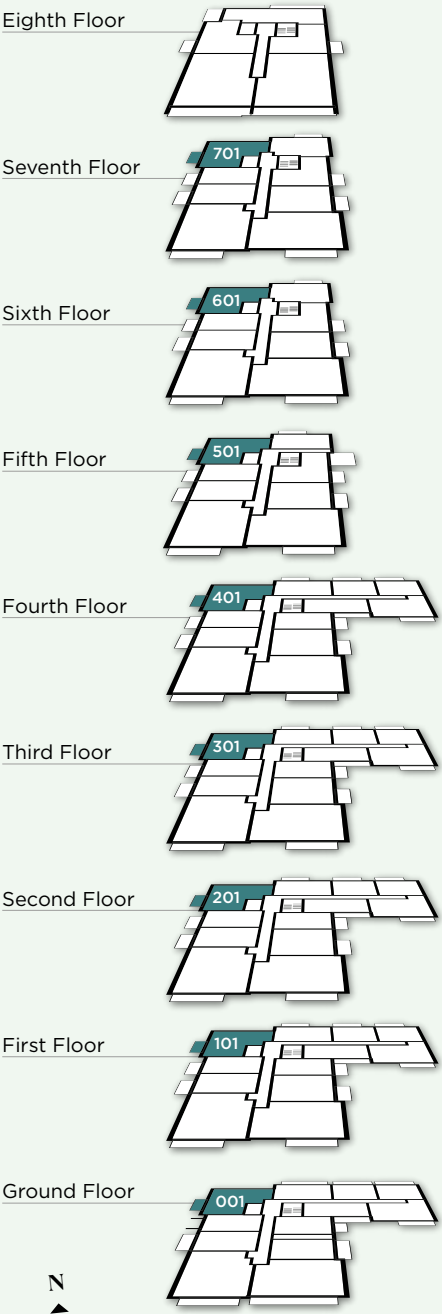

KEY

- W Wardrobe
- C Cupboard
- U Utility
- ◄► Measurement Points
- Bulkhead
- Terrace Area (if applicable)

ARBER HOUSE

2 BEDROOM

TYPE P27
APARTMENTS 110, 210, 310,
410, 506, 606 & 706

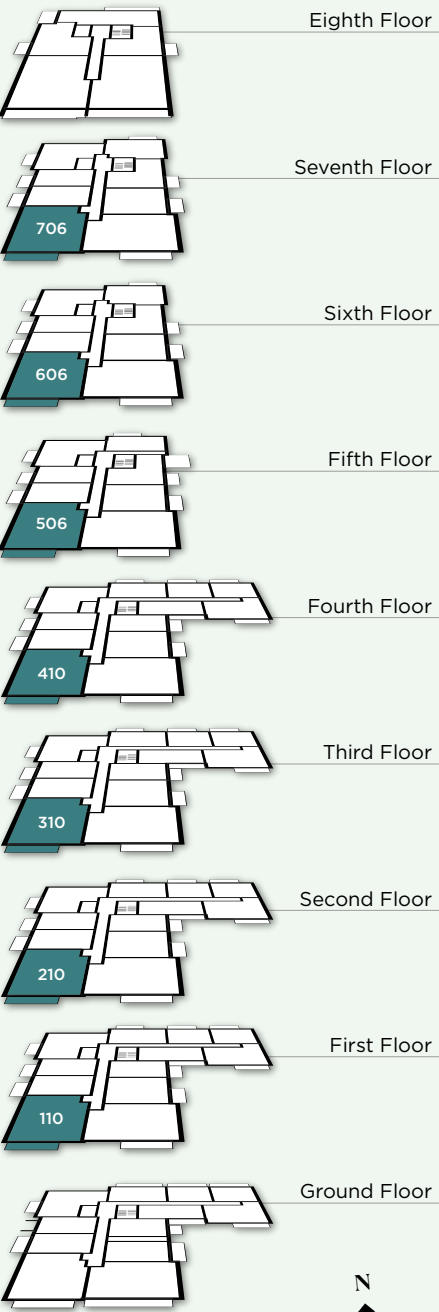

KEY

W

Wardrobe

C

Cupboard

U

Utility

◄►

Measurement Points

.....

Bulkhead

Terrace Area
(if applicable)

THE GREEN QUARTER

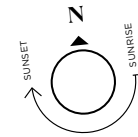

TOTAL AREA	71.40 sq m	768 sq ft	Kitchen	1.92m x 4.24m	6' 4" x 13' 11"
Balcony total area	7.00 sq m	75 sq ft	Living Room	4.82m x 4.24m	15' 10" x 11' 4"
			Bedroom 1	3.35m x 3.65m	11' 0" x 12' 0"
			Bedroom 2	3.35m x 2.74m	11' 0" x 9' 0"
			Balcony	4.72m x 1.50m	15' 5" x 4' 11"

Floorplans shown for The Green Quarter are for approximate measurements only. Exact layout, sizes, measurements and areas may vary within a tolerance of 5%. The net sales area is based on the RICS standard method of measurement and is the internal area of the home including internal columns and service boxing. The dimensions and areas are not intended to be used for carpet sizes, appliance sizes or items of furniture. Furniture and kitchen layouts are indicative only. Colours are indicative only and may vary depending on the customer palette selection. Views are indicative only. Landscaping on balconies and terraces is indicative only. Please note, to increase legibility these plans have been sized to fit the page. As a result this plan may not be at the same scale as those on other pages.

ARBER & EDWIN HOUSE

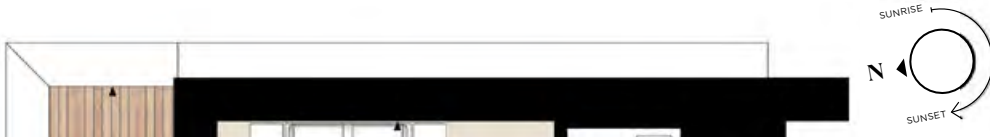

TOTAL AREA	77.52 sq m	834 sq ft	Kitchen	2.90m x 3.73m	9' 6" x 12' 2"
Terraces total area	22.81 sq m	245 sq ft	Living Room	4.01m x 4.88m	13' 2" x 16' 0"
			Bedroom 1	2.90m x 4.07m	9' 6" x 13' 4"
			Bedroom 2	3.10m x 3.73m	10' 2" x 12' 3"
			Terrace 1	2.11m x 5.37m	6' 11" x 17' 7"
			Terrace 2	7.59m x 1.51m	24' 10" x 4' 11"

Floorplans shown for The Green Quarter are for approximate measurements only. Exact layout, sizes, measurements and areas may vary within a tolerance of 5%. The net sales area is based on the RICS standard method of measurement and is the internal area of the home including internal columns and service boxing. The dimensions and areas are not intended to be used for carpet sizes, appliance sizes or items of furniture. Furniture and kitchen layouts are indicative only. Colours are indicative only and may vary depending on the customer palette selection. Views are indicative only. Landscaping on balconies and terraces is indicative only. Please note, to increase legibility these plans have been sized to fit the page. As a result this plan may not be at the same scale as those on other pages.

ARBER HOUSE

2 BEDROOM

TYPE P28
APARTMENT 801

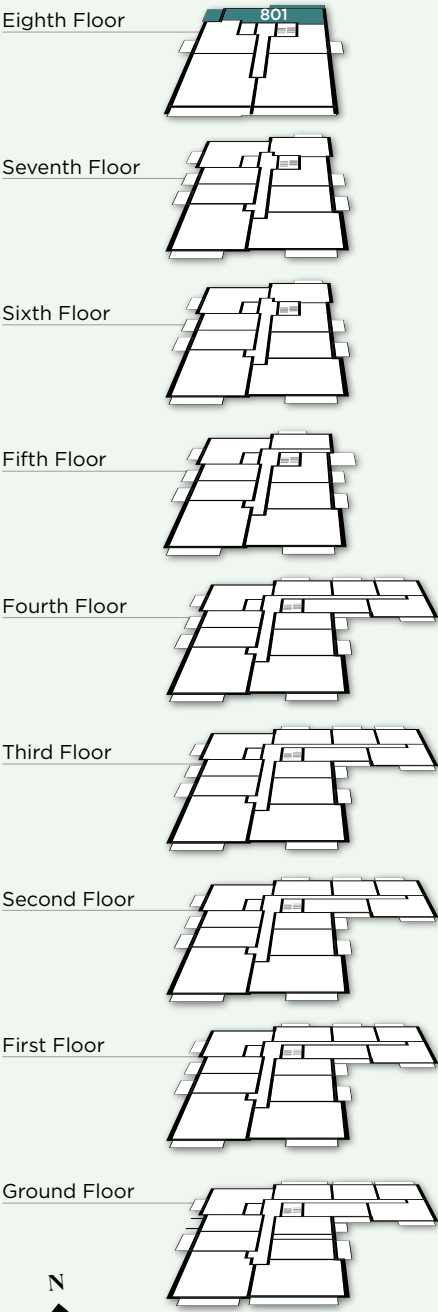

KEY

W

Wardrobe

C

Cupboard

U

Utility

◄►

Measurement Points

.....

Bulkhead

Terrace Area
(if applicable)



FLOORPLANS

EDWIN HOUSE

Suites, 1, 2 & 3 bedroom apartments



EDWIN HOUSE

FLOORPLATES

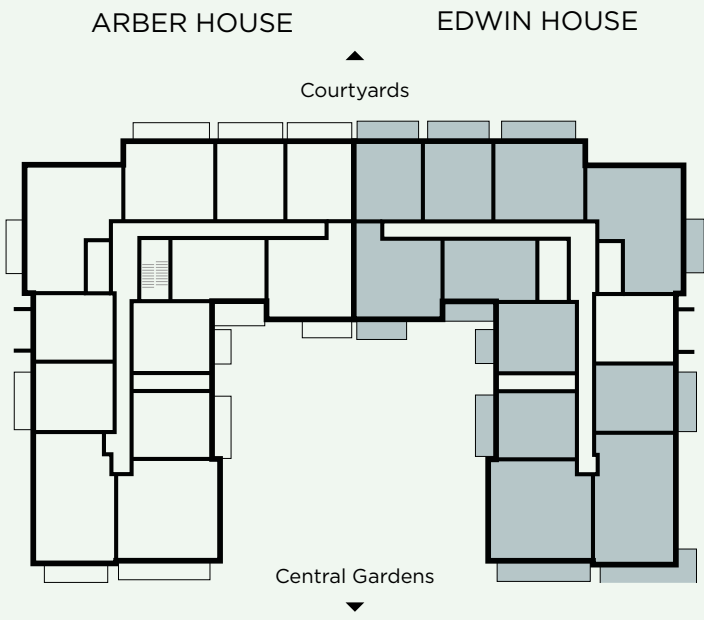

LOCATION MAP

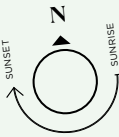
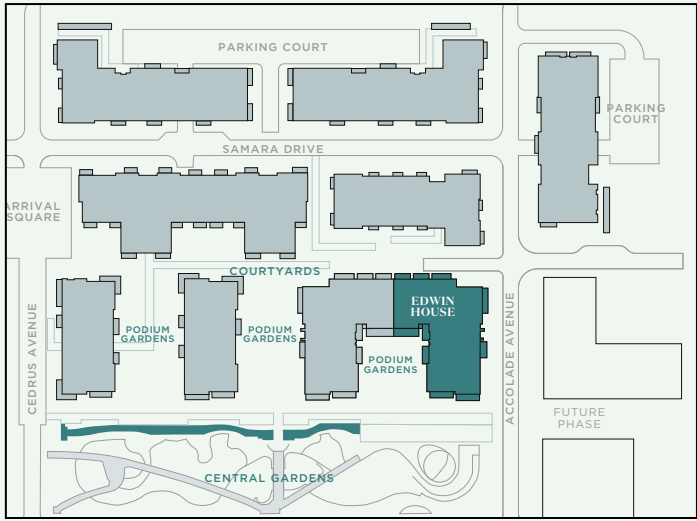

Maps are indicative only and subject to change.

ARBER & EDWIN HOUSE

GROUND FLOOR



FIRST FLOOR



SECOND FLOOR



THIRD FLOOR

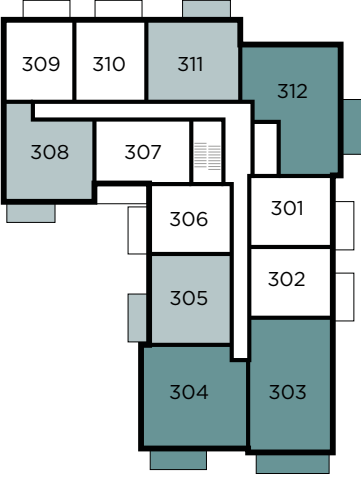

FOURTH FLOOR



FIFTH FLOOR

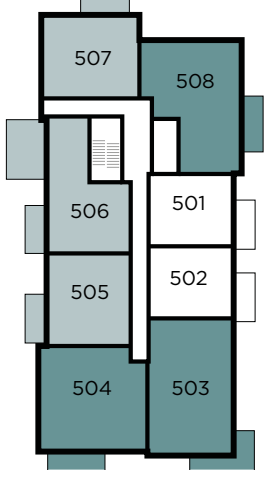

SIXTH FLOOR

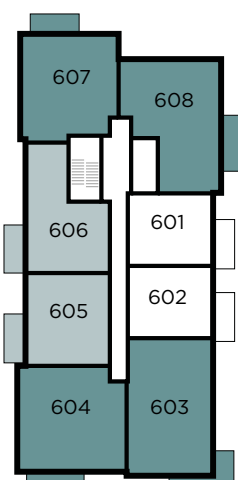

SEVENTH FLOOR

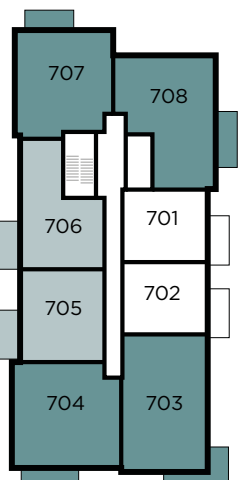

EIGHTH FLOOR

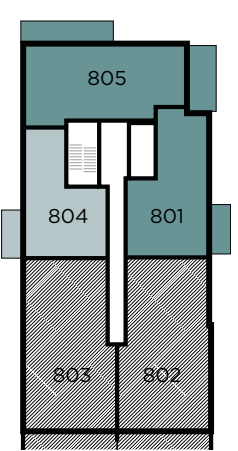

KEY

- Suite Apartments
- 1 Bedroom Apartments
- 2 Bedroom Apartments
- 3 Bedroom Apartments

EDWIN HOUSE

2 BEDROOM

TYPE P20
APARTMENT 801

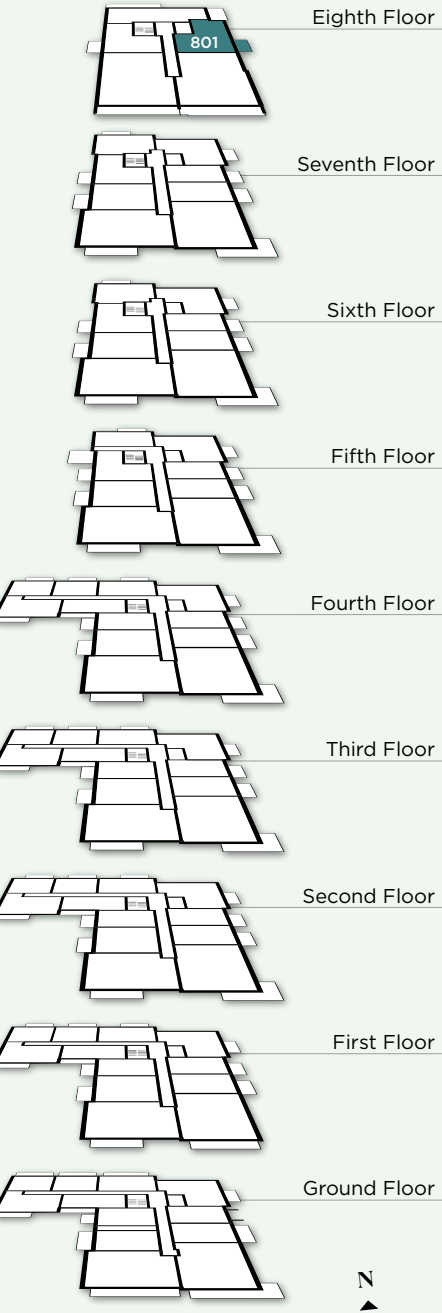

- KEY**
- W Wardrobe
 - C Cupboard
 - U Utility
 - ◄► Measurement Points
 - Bulkhead
 - Terrace Area (if applicable)

THE GREEN QUARTER

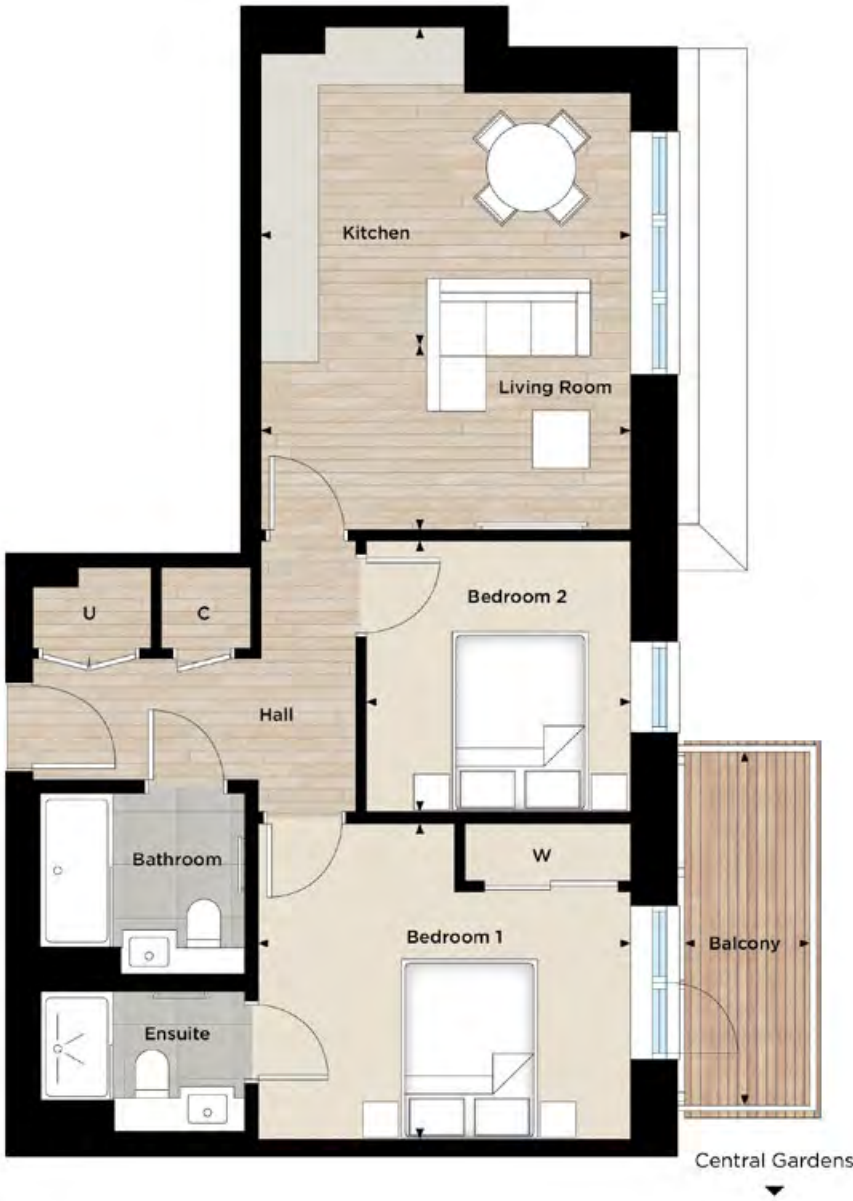
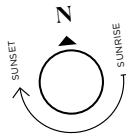

TOTAL AREA	64.67 sq m	696 sq ft	Kitchen	4.09m x 3.69m	13' 5" x 12' 1"
Balcony total area	6.06 sq m	65 sq ft	Living Room	4.09m x 1.86m	13' 4" x 6' 1"
			Bedroom 1	4.11m x 3.50m	13' 5" x 11' 6"
			Bedroom 2	2.93m x 3.00m	9' 7" x 9' 10"
			Balcony	1.50m x 4.04m	4' 11" x 13' 3"

Floorplans shown for The Green Quarter are for approximate measurements only. Exact layout, sizes, measurements and areas may vary within a tolerance of 5%. The net sales area is based on the RICS standard method of measurement and is the internal area of the home including internal columns and service boxing. The dimensions and areas are not intended to be used for carpet sizes, appliance sizes or items of furniture. Furniture and kitchen layouts are indicative only. Colours are indicative only and may vary depending on the customer palette selection. Views are indicative only. Landscaping on balconies and terraces is indicative only. Please note, to increase legibility these plans have been sized to fit the page. As a result this plan may not be at the same scale as those on other pages.

ARBER & EDWIN HOUSE

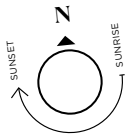

TOTAL AREA	62.34 sq m	671 sq ft	Kitchen	4.24m x 2.52m	13' 11" x 8' 3"
Balcony total area	6.06 sq m	65 sq ft	Living Room	4.24m x 2.83m	13' 11" x 9' 3"
			Bedroom 1	3.31m x 3.31m	10' 10" x 10' 10"
			Bedroom 2	4.24m x 3.13m	13' 11" x 10' 3"
			Balcony	4.04m x 1.50m	13' 3" x 4' 11"

Floorplans shown for The Green Quarter are for approximate measurements only. Exact layout, sizes, measurements and areas may vary within a tolerance of 5%. The net sales area is based on the RICS standard method of measurement and is the internal area of the home including internal columns and service boxing. The dimensions and areas are not intended to be used for carpet sizes, appliance sizes or items of furniture. Furniture and kitchen layouts are indicative only. Colours are indicative only and may vary depending on the customer palette selection. Views are indicative only. Landscaping on balconies and terraces is indicative only. Please note, to increase legibility these plans have been sized to fit the page. As a result this plan may not be at the same scale as those on other pages.

EDWIN HOUSE

2 BEDROOM

TYPE P21
APARTMENTS 607 & 707

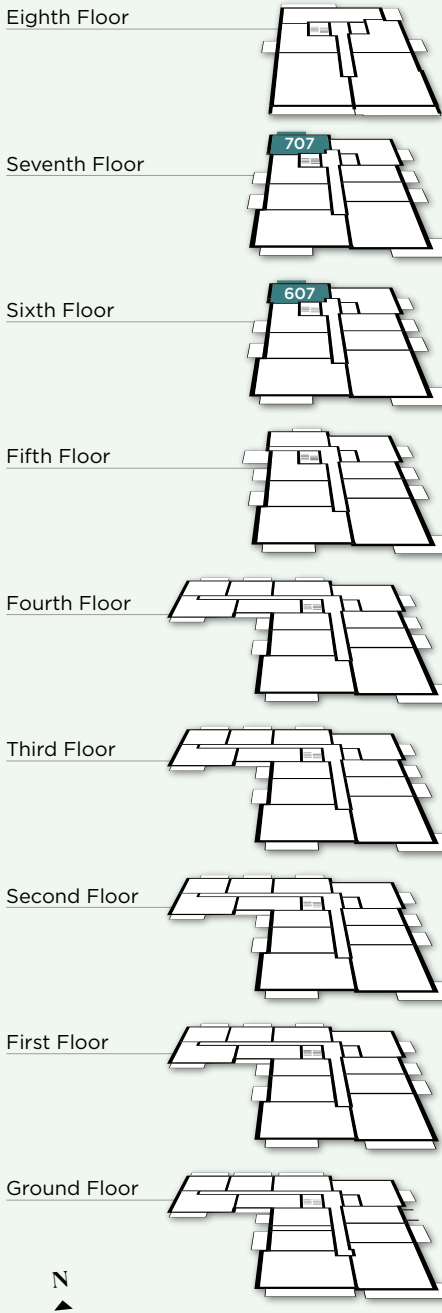

- KEY**
- W Wardrobe
 - C Cupboard
 - U Utility
 - ◄► Measurement Points
 - Bulkhead
 - Terrace Area (if applicable)

EDWIN HOUSE

2 BEDROOM

TYPE P22
APARTMENTS 104, 204, 304,
404, 504, 604 & 704

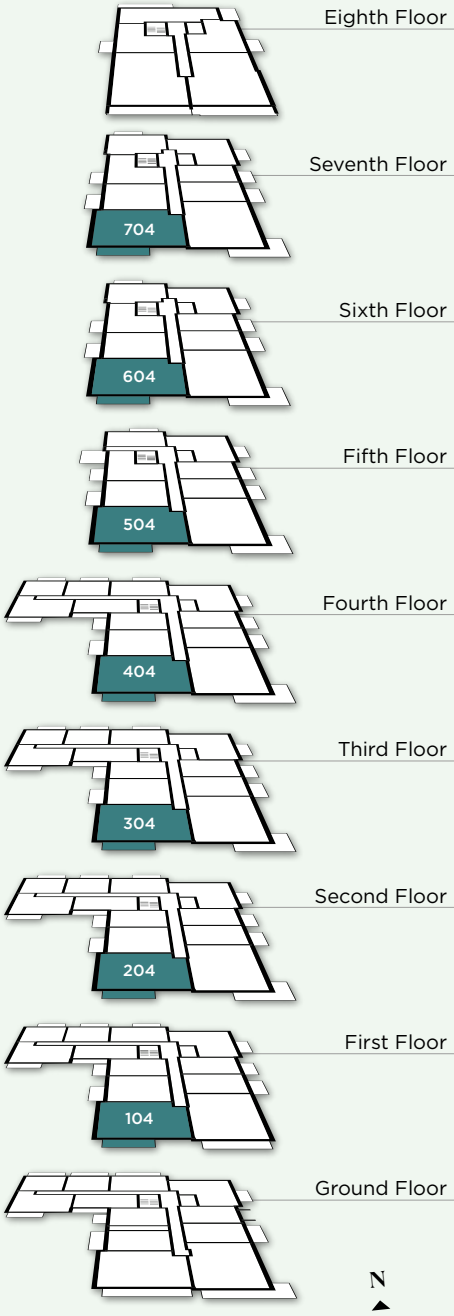

KEY	
W	Wardrobe
C	Cupboard
U	Utility
◄►	Measurement Points
.....	Bulkhead
----	Terrace Area (if applicable)

THE GREEN QUARTER

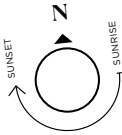

TOTAL AREA	70.61 sq m	760 sq ft	Kitchen	3.18m x 2.52m	10' 5" x 8' 3"
Balcony total area	7.08 sq m	76 sq ft	Living Room	5.08m x 2.64m	16' 8" x 8' 8"
			Bedroom 1	5.08m x 3.10m	16' 8" x 10' 2"
			Bedroom 2	3.54m x 2.75m	11' 7" x 9' 0"
			Balcony	4.72m x 1.50m	15' 5" x 4' 11"

Floorplans shown for The Green Quarter are for approximate measurements only. Exact layout, sizes, measurements and areas may vary within a tolerance of 5%. The net sales area is based on the RICS standard method of measurement and is the internal area of the home including internal columns and service boxing. The dimensions and areas are not intended to be used for carpet sizes, appliance sizes or items of furniture. Furniture and kitchen layouts are indicative only. Colours are indicative only and may vary depending on the customer palette selection. Views are indicative only. Landscaping on balconies and terraces is indicative only. Please note, to increase legibility these plans have been sized to fit the page. As a result this plan may not be at the same scale as those on other pages.

ARBER & EDWIN HOUSE

EDWIN HOUSE

2 BEDROOM

TYPE P22(V2)
APARTMENT 003

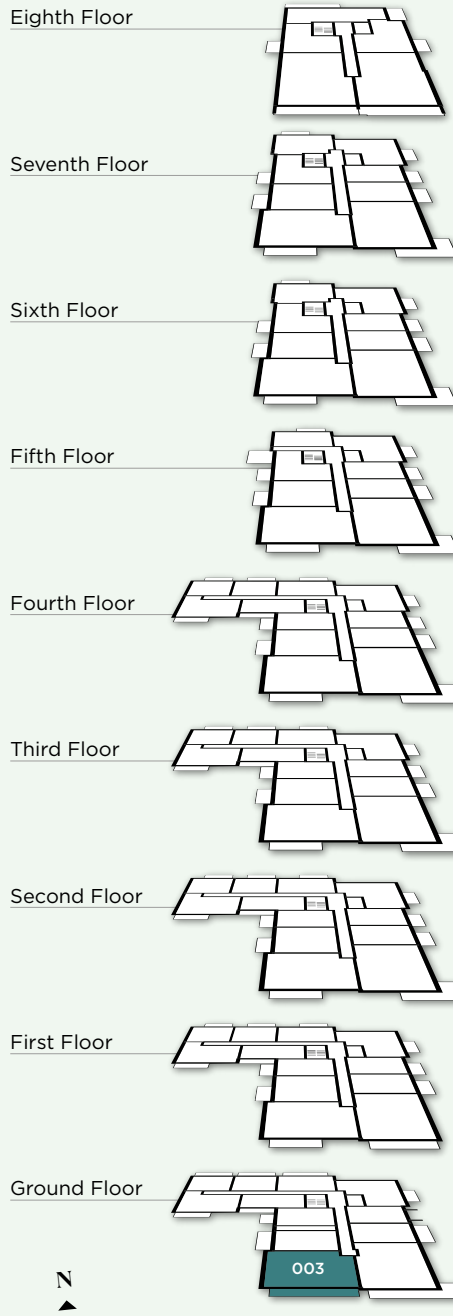

TOTAL AREA	71.18 sq m	766 sq ft	Kitchen	3.18m x 2.52m	10' 5" x 8' 3"
Terrace total area	12.06 sq m	129 sq ft	Living Room	5.08m x 2.64m	16' 8" x 8' 8"
			Bedroom 1	5.08m x 3.10m	16' 8" x 10' 2"
			Bedroom 2	3.54m x 2.76m	11' 7" x 9' 1"
			Terrace	8.04m x 1.50m	26' 4" x 4' 11"

Floorplans shown for The Green Quarter are for approximate measurements only. Exact layout, sizes, measurements and areas may vary within a tolerance of 5%. The net sales area is based on the RICS standard method of measurement and is the internal area of the home including internal columns and service boxing. The dimensions and areas are not intended to be used for carpet sizes, appliance sizes or items of furniture. Furniture and kitchen layouts are indicative only. Colours are indicative only and may vary depending on the customer palette selection. Views are indicative only. Landscaping on balconies and terraces is indicative only. Please note, to increase legibility these plans have been sized to fit the page. As a result this plan may not be at the same scale as those on other pages.

EDWIN HOUSE

2 BEDROOM

TYPE P23
APARTMENT 002

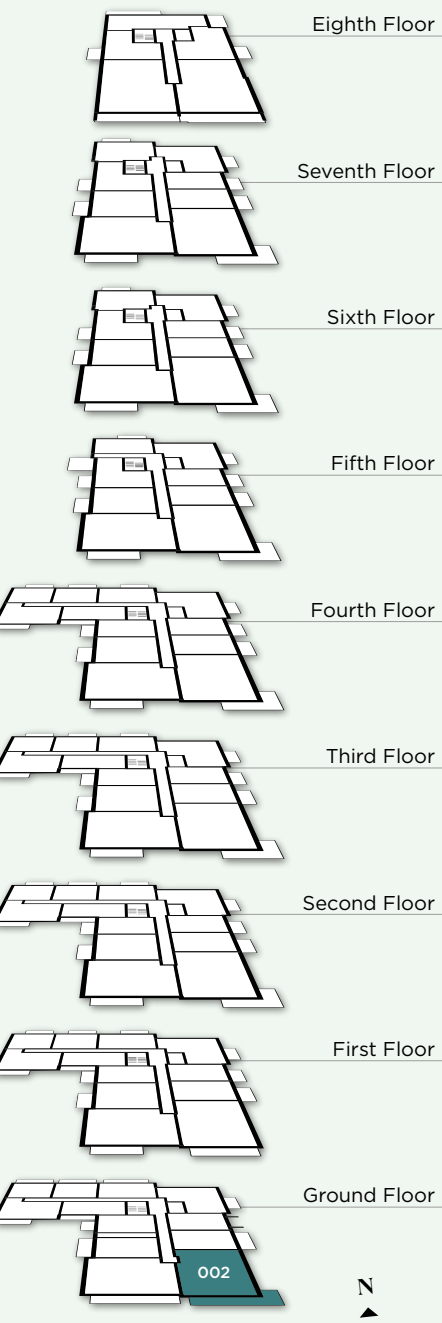

KEY

- W Wardrobe
- C Cupboard
- U Utility
- ◄► Measurement Points
- Bulkhead
- Terrace Area (if applicable)

THE GREEN QUARTER

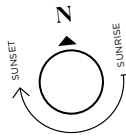

TOTAL AREA	70.92 sq m	763 sq ft	Kitchen	1.92m x 4.15m	6' 4" x 13' 8"
Terrace total area	14.77 sq m	158 sq ft	Living Room	4.82m x 4.15m	15' 10" x 13' 8"
			Bedroom 1	3.35m x 3.65m	11' 0" x 12' 0"
			Bedroom 2	3.35m x 2.84m	11' 0" x 9' 4"
			Terrace	8.25m x 1.50m	27' 0" x 4' 11"

Floorplans shown for The Green Quarter are for approximate measurements only. Exact layout, sizes, measurements and areas may vary within a tolerance of 5%. The net sales area is based on the RICS standard method of measurement and is the internal area of the home including internal columns and service boxing. The dimensions and areas are not intended to be used for carpet sizes, appliance sizes or items of furniture. Furniture and kitchen layouts are indicative only. Colours are indicative only and may vary depending on the customer palette selection. Views are indicative only. Landscaping on balconies and terraces is indicative only. Please note, to increase legibility these plans have been sized to fit the page. As a result this plan may not be at the same scale as those on other pages.

ARBER & EDWIN HOUSE

EDWIN HOUSE

2 BEDROOM

TYPE P24
APARTMENTS 011**, 112, 212,
312, 412, 508, 608 & 708

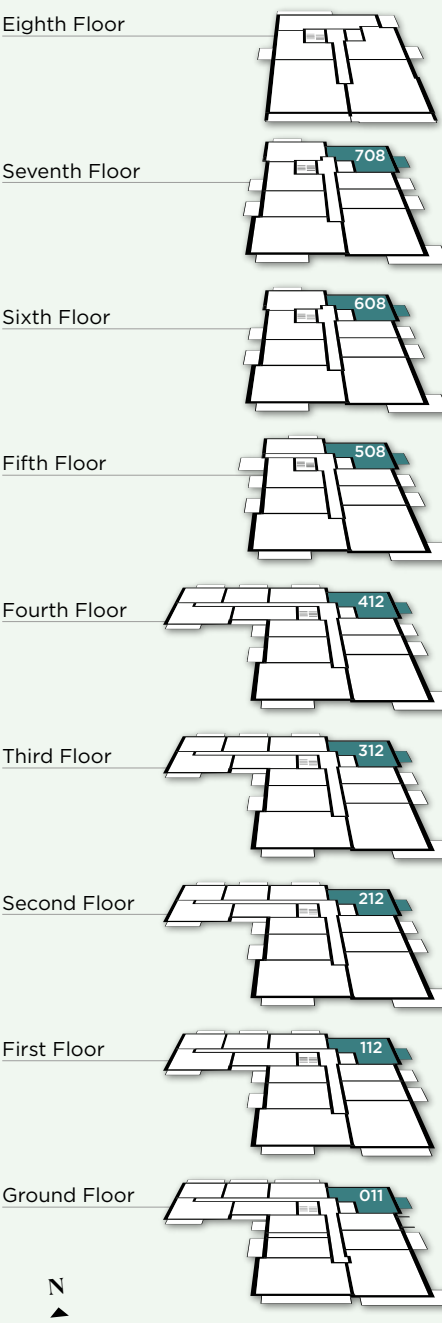

KEY

- W Wardrobe
- C Cupboard
- U Utility
- ◄► Measurement Points
- Bulkhead
- Terrace Area (if applicable)



TOTAL AREA	70.84 sq m	762 sq ft	Kitchen	1.86m x 4.40m	6' 1" x 14' 4"
Balcony total area	7.00 sq m	75 sq ft	Living Room	3.01m x 6.75m	9' 10" x 22' 1"
Terrace total area	8.92 sq m	96 sq ft	Bedroom 1	2.97m x 3.11m	9' 9" x 10' 2"
			Bedroom 2	2.75m x 3.52m	9' 0" x 11' 6"
			Balcony	1.50m x 4.72m	4' 11" x 15' 5"
			Terrace	2.01m x 4.45m	6' 7" x 14' 7"

**Apartment 011 is a ground floor apartment and has a terrace in place of a balcony.

Floorplans shown for The Green Quarter are for approximate measurements only. Exact layout, sizes, measurements and areas may vary within a tolerance of 5%. The net sales area is based on the RICS standard method of measurement and is the internal area of the home including internal columns and service boxing. The dimensions and areas are not intended to be used for carpet sizes, appliance sizes or items of furniture. Furniture and kitchen layouts are indicative only. Colours are indicative only and may vary depending on the customer palette selection. Views are indicative only. Landscaping on balconies and terraces is indicative only. Please note, to increase legibility these plans have been sized to fit the page. As a result this plan may not be at the same scale as those on other pages.

EDWIN HOUSE

2 BEDROOM

TYPE P27
APARTMENTS 103*, 203, 303,
403, 503, 603 & 703

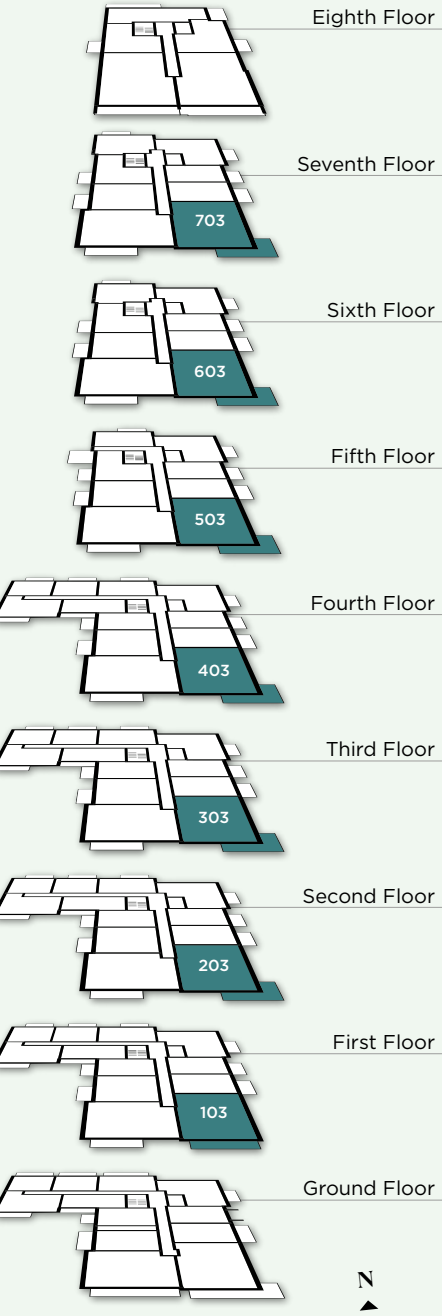

- KEY**
- W Wardrobe
 - C Cupboard
 - U Utility
 - ◀▶ Measurement Points
 - Bulkhead
 - Terrace Area (if applicable)

THE GREEN QUARTER

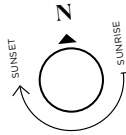

TOTAL AREA	71.40 sq m	768 sq ft	Kitchen	1.92m x 4.24m	6' 4" x 13' 11"
Balcony total area	11.50 sq m	123 sq ft	Living Room	4.82m x 4.24m	15' 10" x 11' 4"
Balcony total area (103)	9.60 sq m	103 sq ft	Bedroom 1	3.35m x 3.65m	11' 0" x 12' 0"
			Bedroom 2	3.35m x 2.74m	11' 0" x 9' 0"
			Balcony	5.32m x 3.70m x 1.50m	17' 5" x 12' 2" x 4' 11"
			Balcony (103)	6.40m x 1.50m	21' 0" x 4' 11"

*Apartment 103 has a straight balcony rather than a corner balcony.

Floorplans shown for The Green Quarter are for approximate measurements only. Exact layout, sizes, measurements and areas may vary within a tolerance of 5%. The net sales area is based on the RICS standard method of measurement and is the internal area of the home including internal columns and service boxing. The dimensions and areas are not intended to be used for carpet sizes, appliance sizes or items of furniture. Furniture and kitchen layouts are indicative only. Colours are indicative only and may vary depending on the customer palette selection. Views are indicative only. Landscaping on balconies and terraces is indicative only. Please note, to increase legibility these plans have been sized to fit the page. As a result this plan may not be at the same scale as those on other pages.

ARBER & EDWIN HOUSE

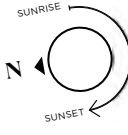

TOTAL AREA	77.52 sq m	834 sq ft	Kitchen	2.90m x 3.73m	9' 6" x 12' 2"
Terraces total area	22.81 sq m	245 sq ft	Living Room	4.01m x 4.88m	13' 2" x 16' 0"
			Bedroom 1	2.90m x 4.07m	9' 6" x 13' 4"
			Bedroom 2	3.10m x 3.73m	10' 2" x 12' 3"
			Terrace 1	2.11m x 5.37m	6' 11" x 17' 7"
			Terrace 2	7.59m x 1.51m	24' 10" x 4' 11"

Floorplans shown for The Green Quarter are for approximate measurements only. Exact layout, sizes, measurements and areas may vary within a tolerance of 5%. The net sales area is based on the RICS standard method of measurement and is the internal area of the home including internal columns and service boxing. The dimensions and areas are not intended to be used for carpet sizes, appliance sizes or items of furniture. Furniture and kitchen layouts are indicative only. Colours are indicative only and may vary depending on the customer palette selection. Views are indicative only. Landscaping on balconies and terraces is indicative only. Please note, to increase legibility these plans have been sized to fit the page. As a result this plan may not be at the same scale as those on other pages.

EDWIN HOUSE

2 BEDROOM

TYPE P28
APARTMENT 805

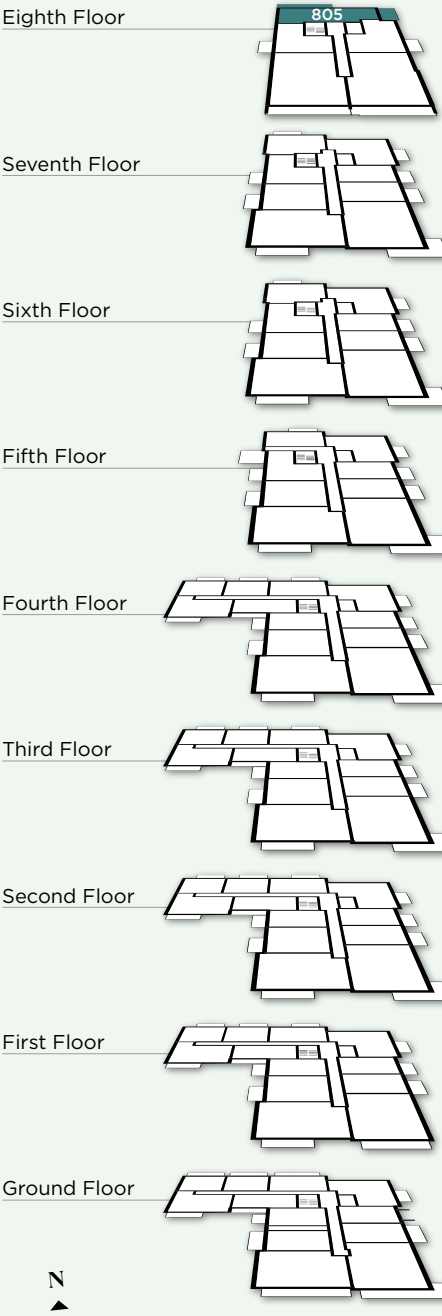

- KEY**
- W Wardrobe
 - C Cupboard
 - U Utility
 - ◀▶ Measurement Points
 - Bulkhead
 - Terrace Area (if applicable)

DESIGNED FOR LIFE

At Berkeley, we are committed to creating great places where people love to live, work and relax. Where the homes are light-filled, adaptable and finished to very high standards. Where carefully planned public areas enhance well-being and quality of life for residents and visitors. Where people feel a sense of community.

CUSTOMERS DRIVE ALL OUR DECISIONS

We achieve that by putting our customers at the heart of everything we do. First, we strive to understand what our customers want and need – well-built homes, in a pleasant and safe neighbourhood, with plenty of amenities and good transport connections. Then we apply that understanding to all our planning and design decisions.

And for every new development, we challenge ourselves to go further, to improve and innovate, ensuring we satisfy the real needs of our customers in inspiring and sustainable ways.

CHOICE AND DIVERSITY

No two Berkeley customers are the same, so we aim to offer a wide choice of property location, size and type. From central London to major towns and cities; from market towns to rural villages, countryside to the coast – we build in locations our customers love. And whatever home you are looking for, whether that's a city penthouse, a modern studio apartment or traditional family home, you will find the perfect fit for your lifestyle.

QUALITY FIRST TO LAST

Quality is the defining characteristic of Berkeley developments, right down to the very last detail. We choose our locations, style of homes, construction practices, materials and specifications with great care. When you buy a new home from Berkeley you can be safe in the knowledge that it is built to high standards of design and quality, has low environmental impact and that you will receive a professional, efficient and helpful service from us. For extra peace of mind, all new properties come with a 10-year build warranty.

GREEN LIVING

For Berkeley, sustainability isn't simply the latest buzzword. We are committed to creating a better environment within our developments and in the areas that surround them. That's why we build on brownfield sites whenever we can, bringing new life to disused and unloved spaces. We take care to protect the natural environment and enhance biodiversity. All our homes are designed to reduce water and energy consumption, and to enable residents to recycle waste.

COMMITMENT TO THE FUTURE

When we plan a development, we take a long-term view of how the community we create can thrive in years to come. Our aim is to permanently enhance the neighbourhoods in which they are located, through intelligent design, quality landscaping, sympathetic architecture or restoration, and high standards of sustainability. We don't just build for today; we build for the future too.

**CONSUMER
CODE FOR
HOME BUILDERS**
www.consumercode.co.uk

TRANSFORMING TOMORROW

At Berkeley Group our passion and purpose is to build quality homes, strengthen communities and improve people's lives. We are innovating, pushing boundaries and taking action to ensure we have a long-term, positive impact that is good for our customers, the communities we touch, our business and the world around us. We transform underused sites into exceptional places and we're also transforming the way we work; embracing technology and raising standards, as we continue to deliver an outstanding customer experience and create high-quality homes that delight our customers. Our Vision 2030 is our ten year plan which sets out how we will achieve this.



TRANSFORMING PLACES

Working with local people and partners we create welcoming and connected neighbourhoods where you can be proud to live.



TRANSFORMING LIFESTYLES

Taking action on climate change and giving you ways to live more sustainably. We're building efficient homes that use less energy over their lifetime, with sustainable travel choices on the doorstep.



TRANSFORMING NATURE

Creating beautiful places with habitats that help nature to thrive, meaning that every site is left with more nature than when we began.



TRANSFORMING FUTURES

Helping people to reach their potential through apprenticeships and training, and programmes supported by the Berkeley Foundation.



Please scan this QR code for more information on how we are TRANSFORMING TOMORROW

THIS IS HOW WE ARE ENSURING SUSTAINABILITY AT THE GREEN QUARTER

PEOPLE, PLANET, PROSPERITY

Sustainability is fundamental to Berkeley's ethos. In simple terms, we want to ensure the long-term health, wellbeing and prosperity of people and the planet. There are a range of ways we are managing and minimising the environmental impact of our operations and delivery of homes and communities. These are the initiatives we have implemented at The Green Quarter.

NATURE AND BIODIVERSITY

Parkland, trees, flowers, green roofs, ponds, hedges, gardens – these are the fundamentals of a thriving natural environment that can be enjoyed by everyone. They are all part of our commitment to net biodiversity gain on our developments. Within and around The Green Quarter, we have created natural habitats that encourage wildlife to flourish. We are working with the London Wildlife Trust and ALD (Applied Landscaping Design) to engage residents in the natural landscapes that we have created.

WASTE AND RECYCLING

We actively encourage all residents to reduce their waste wherever possible. In addition to external recycling bins, we provide integrated recycling bins in kitchens to make it easier to separate and recycle waste.

WATER EFFICIENCY

Our homes are designed to high water efficiency standards and are fitted with dual flush WCs, and low-flow taps and showerheads which use less water without compromising convenience and comfort. We also suggest simple steps to reduce water consumption, such as not leaving taps running unnecessarily.

ENERGY EFFICIENCY

Efficient use of electricity and gas helps lower fuel bills and reduces carbon emissions. Our homes have been designed to use less energy than a standard home. They have enhanced levels of thermal insulation, air-tightness and Continuous Mechanical Extract Ventilation. All lighting is low energy and kitchen appliances are B rated or above.

NOISE REDUCTION

We can't eliminate noise, but we consider the impact of noise in the design of our homes. We consider external noise, such as from nearby roads, and internal noise including the transfer between rooms and floors. We incorporate measures to reduce the different types of noise wherever possible to create a quieter environment.

CLEAN AIR

It is hard to avoid polluted air, particularly in our cities. Throughout The Green Quarter we have planted trees, shrubs and flower beds to help create a cleaner air environment. Within our homes we provide mechanical ventilation to filter the internal air.

SUSTAINABLE TRANSPORT

The Green Quarter is within walking distance of the railway station. Electric car charging points, car club and fitness trails encourage the use of sustainable methods of transport, to help reduce air pollution around the development and the wider area. These active methods of transport also help encourage healthier lifestyles.

STEWARDSHIP

Maintaining our communal open spaces and facilities in perpetuity is an important benefit to the whole community. We work with Firstport and residents to ensure the development remains in pristine condition.

FUTURE-PROOF DESIGN

From the early stages of design, we assess how our homes will stand up to the future effects of climate change, such as how they will be affected by higher summer temperatures, periods of drought, or more extreme rainfall. We are constantly researching how we can ensure our homes and developments are more resilient to these extremes to understand what new innovative technologies we should use in our future designs.

INTRODUCING MYHOME PLUS



WHAT IS MYHOME PLUS?

MyHome Plus is an online service that is designed to help you manage key aspects of your new home at any time from anywhere around the world.

**SIGN IN BY VISITING
BERKELEYGROUP.CO.UK/MY-HOME/SIGN-IN**

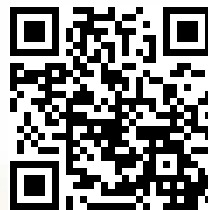

**PLEASE SCAN TO
SEE MORE ABOUT
MYHOME PLUS**

BUYING PROCESS

This section provides you with an overview of MyHome Plus Key features to enhance your customer journey.

01

FILING CABINET

In the filing cabinet section you can access documentation relating to your new home immediately at your own convenience.

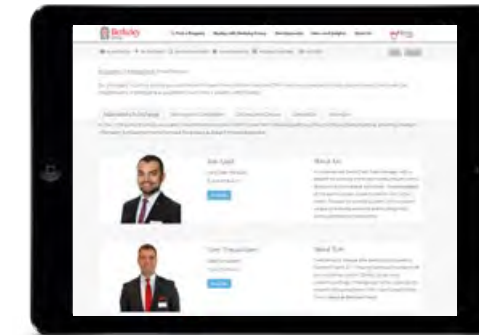

02

MEET THE TEAM

This section provides an introduction to your dedicated Sales Consultant, Customer Relations Manager and Customer Service Manager. You will be able to view their contact details and to contact them directly from the platform.



03

OPTIONS & CHOICES

When you buy a home with us, you will have the option to choose some of your home finishes. This will be subject to the development and property building stage but it's a chance to make it feel truly yours. You will be able to see the different options, the selection deadline date and submit your choice in this section of MyHome Plus. See the "next steps" section for further detail on this.

04

CONSTRUCTION PROGRESS

Under this section, regular updates on the construction of your new property will be provided, keeping you up to date on the progress on site and the local area.

Your Customer Relations Manager will issue regular newsletters and photographs to this section throughout your journey.

05

MY GUIDES

View and download your buying and living guides to support you step-by-step through your journey with us.

NEXT STEPS

01

Your Sales Consultant will send you instructions to create and validate your MyHome account. Once your account is validated, your Sales Consultant will assign your property to your MyHome account and your account will be upgraded to a MyHome Plus account.

02

Your Customer Relations Manager will then be in touch to invite you in to our Show Apartment to view the interior selections available for the internal finishes that you have an option to select.*

*If you cannot make it to the appointment, the options can be discussed over the telephone and selected via MyHome Plus. Customer Service will need to receive your choices selection by the deadline date, which will be given in advance.

OUR RECENT ACCOLADES

The Berkeley Group, and all the companies within the Group, has continued to strive for the best, and has received many awards for design, construction and health & safety.

It is not only experts from our industry we have received recognition from, 98% of our customers would recommend us to a friend.



Britain's Most Admired Companies 2020
Sixth most admired company in Britain and placed first within the Home Construction category.



CDP Climate Change A-List 2020
Awarded A-rating for Climate Action and Transparency



Housebuilder Awards 2020
Sustainable Developer of the Year



In-house Research Awards 2022
Outstanding Award 2022 and 2022 Gold Award for Customer Satisfaction



Investor in Customers®
Gold 2018



Investor in Customers®
Gold 2020



Investor in Customers®
Gold 2022

Investor in Customers
Gold 2018, 2020 and 2022



The EG Future of Real Estate Awards 2019
National Company of the Year
Future of Real Estate Award



Building Awards 2019
Housebuilder of the Year



International Property Awards 2019
Best Residential Development (100+ units) – Abell & Cleland
Best Sustainable Development – Kidbrooke Village
Best Mixed-Use Development – Kidbrooke Village



CONTACT US

MARKETING SUITE ADDRESS:

1 Randolph Road, Southall UB1 1BL

Opening Times

Monday to Saturday 10am – 6pm

Sunday 10am – 5pm

Bank Holidays 10am – 4pm

For more information please

visit our website or contact

our Sales Team:

www.the-green-quarter.com

tgqsales@berkeleygroup.co.uk

T: 020 3930 5295

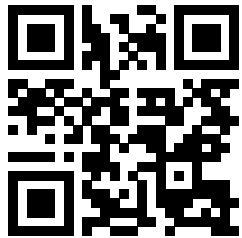

Please scan to
see the location
on Google maps

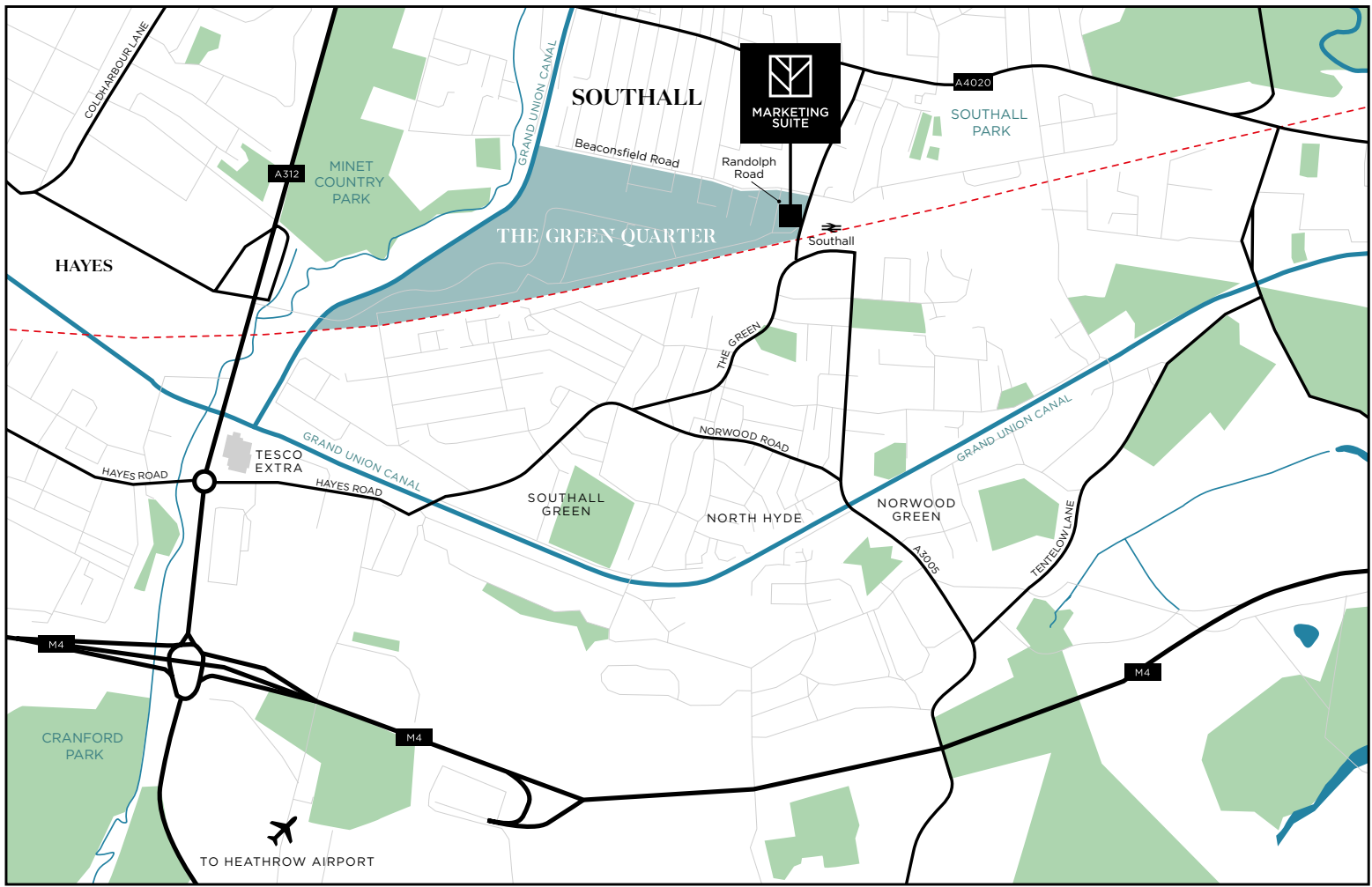

Map not to scale



The information in this document is indicative and is intended to act as a guide only as to the finished product. Accordingly, due to Berkeley's policy of continuous improvement, the finished product may vary from the information provided. It may not be possible to provide the exact materials as referred to in the brochure. In such cases a suitable alternative will be provided. [DEVELOPER NAME] reserves the right to make these changes as required. These particulars should not be relied upon as statements of fact or representations and applicants must satisfy themselves by inspection or otherwise as to their correctness. This information does not constitute a contract or warranty. The dimensions given on plans are subject to minor variations and are not intended to be used for carpet sizes, appliance sizes or items of furniture. The Green Quarter is a marketing name and will not necessarily form part of the approved postal address. Applicants are advised to contact Berkeley to ascertain the availability of any particular property. The Green Quarter was granted planning permission by Hillingdon Council (planning reference: 54814/APP/2017/604 dated 19 September 2017) and Ealing Council (planning reference: 171562VAR dated 16 October 2017). Through the purchase of a property at The Green Quarter, the buyer is acquiring an apartment with a 999-year leasehold. Like any investment, purchasing uncompleted properties situated outside Hong Kong is complicated and contains risk. You should review all relevant information and documents carefully before making a purchase decision. If in doubt, please seek independent professional advice before making a purchase decision. A724/05CA/0522.



